

# *User's Manual*

## **Vacuum Fluorescent Customer Display**

**MODEL : WD-202P\***

**Version: 1.38**

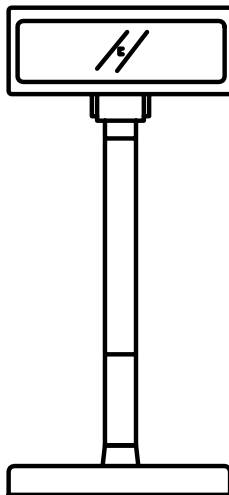

<b>1. FEATURES .....</b>	<b>3</b>
<b>2. GENERAL SPECIFICATIONS.....</b>	<b>4</b>
<b>3. UNPACKING AND CHECKING THE PARTS.....</b>	<b>5</b>
<b>4. INTERFACE .....</b>	<b>6</b>
4.1 POWER SUPPLY CONNECTORS .....	6
4.2 PARALLEL INTERFACE (CONNECT TO PC/HOST) .....	7
4.3 RS232C INTERFACE (TRANSFER TO DISPLAY) .....	8
4.4 RS232C INTERFACE (PASS THROUGH TO PRINTER) .....	9
<b>5. DIP SWITCH SETTING .....</b>	<b>10</b>
5.1 COMMAND TYPE SELECTION .....	10
5.2 BAUD RATE SELECTION .....	10
5.3 PARITY CHECK SELECTION.....	10
5.4 INTERNATIONAL CHARACTER SET SELECTION.....	11
5.5 SELF-TEST & DEMO FUNCTION SELECTION .....	11
<b>6. COMMAND.....</b>	<b>12</b>
6.1 CD5220 STANDARD MODE COMMAND LIST .....	12
6.2 UTC STANDARD MODE COMMAND LIST .....	15
6.3 UTC ENHANCED MODE COMMAND LIST .....	15
6.4 AEDEX MODE COMMAND LIST .....	16
6.5 ADM787/788 MODE COMMAND LIST .....	16
6.6 DSP-800 MODE COMMAND LIST .....	17
6. 7 EPSON Esc/POS COMMAND LIST .....	18
<b>7. CHARACTER SET.....</b>	<b>21</b>
7.1 USA,STANDARD CHARACTER SET (20H – 7EH).....	21
7.2 INTERNATION CHARACTER SETS .....	22
7.3 PAGE 0 (PC437: USA, STANDARD EUROPE) (80H – FFH) .....	23
7.4 PAGE 1 (KATAKANA) (80H – FFH) .....	24
7.5 PAGE 2 (PC850: MULTILINGUAL) (80H – FFH) .....	25
7.6 PAGE 3 (PC860: PORTUGUESE) (80H – FFH) .....	26
7.7 PAGE 4 (PC863: CANADIAN-FRENCH) (80H – FFH) .....	27
7.8 PAGE 5 (PC865: NORDIC) (80H – FFH).....	28
7.9 PAGE 6 (SLAVONIC) (80H – FFH) .....	29
7.10 PAGE 7 (RUSSIA) (80H – FFH).....	30
7.11 PAGE 19 (PC858 EURO) (80H – FFH).....	31
7.12 PAGE 16 (WPC1252) (80H – FFH).....	32
7.13 PAGE 12 (GREEK) (80H – FFH).....	33

***WD-202P customer display***

---

**APPENDIX A: CUSTOMER DISPLAY DIMENSION .....34**

**APPENDIX B: DISPLAY BASE DIMENSION .....34**

**APPENDIX C: DISPLAY MODULE DIMENSION .....35**

**APPENDIX D: PASS THROUGH INSTALLATION GUIDE.....36**

## **1. FEATURES**

- 1.) Data can be displayed on 20 columns x 2 lines.
- 2.) Blue-green color and large character are easy to eyes.
- 3.) The display panel is adjustable to provide the best view angle.
- 4.) Provide 2 pole for best position installation.
- 5.) The DIP-switches setting emulate commands mode, baud rate and international characters.
- 6.) CD5220/UTC/EMAX/ADM/EscPOS/DSP-800 emulation command sets.
- 7.) User-defined characters can be downloaded ( for EscPOS /CD5220/DSP-800 command).
- 8.) Display area can be controlled by window function ( for EscPOS command only).
- 9.) Provides a centronics interface link to PC Host, and auto transfer to display panel and pass through to printer by RS232C with baud rate fixed at 9600 bps.
- 10.) Multy power connectable and wide range power input (9 – 45 Vdc).

**2. GENERAL SPECIFICATIONS**

NO	ITEM	Descriptions
1	Display method	Vacuum fluorescent display
2	Numberof character	40 characters ( 20 columns x 2 lines)
3	Character font	5 x 7 Dot matrix
4	Display color	Blue green
5	Brightness	700 cd/m <sup>2</sup>
6	Character type	96 alphanumeric 13 kinds of international character set 1 kind of user define character
7	Character size	9.2 mm x 5. 25 mm
8	Power supply	9 - 45Vdc
9	Power consumption	3 – 6 W
10	MTBF	25000 hours (power on time)
11	Panel dimensions	224 (W) x 93 (H) x 50(D) mm
12	Support dimensions	Long support : 219 mm Short support : 88 mm
13	Base dimensions	190(w)x55(h)x96(d)mm
14	Viewing angle	-5 - 60 degrees
15	Rotation angle	Maximum 270 degrees
16	Weight	1.25 Kg
17	Operating temperature	5 – 45
18	Operating Humidity	30%-85%
19	Storage Temperature	-10 - 55
20	Storage Humidity	10%-85%

Table 2-1

### **3. UNPACKING AND CHECKING THE PARTS**

#### **Parts list:**

- (1) Display Module.
- (2) Right Knob.
- (3) Left Knob.
- (4) Display Cable.
- (5) Neck.
- (6) Long Pole.
- (7) Short Pole.
- (8) Base Housing.
- (9) Base PCB.
- (10) Power Adapter (option)
- (11) Parallel Cable.

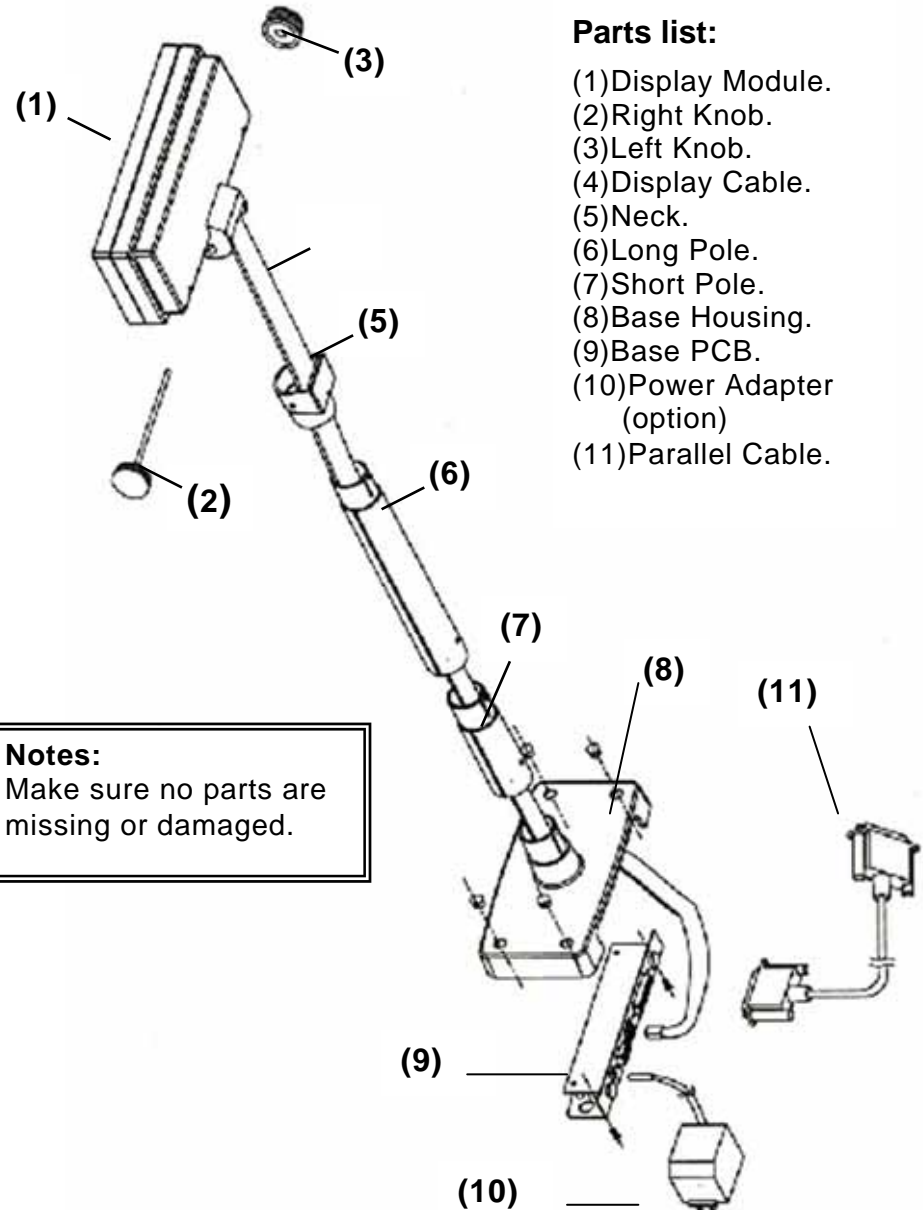

#### **Notes:**

Make sure no parts are missing or damaged.

## 4. INTERFACE

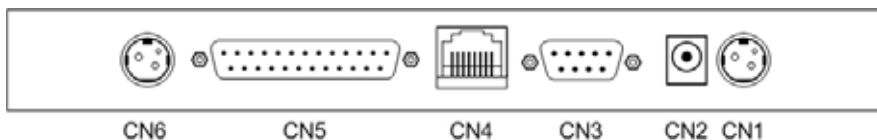

CN1,CN6: 24Vdc power supply pass-through connects

CN2:Power input connector from adapter

CN3: RS-232C connect to printer

CN4: Connect to display pannel

CN5:Parallel port connect to PC/Host

Data flow : PC/host to display, Display to printer,

Handshaking flow : Display to PC/host, printer to display,

Table 4-2

**Note:** There are 200 bytes resident buffer in the display for pass data to printer.If PC/host keep transmitting the data to printer when the display inactive DTR or RTS , data will be lost.

### 4.1 Power Supply Connectors

The varibale power input which are available on base connectors, but only if one connector can be selected for power input, the description as below:

#### 4.1.1 CN2 / Type: DC jack (5.5/2.1)

Pin assignment

No	Signal	
+	Vin1	
-	GND	

#### 4.1.2 CN1,CN6 / Type: Miniature jacks quick lock 3 pin

Pin assignment

No	Signal	
1	Vin2	
2	GND	

## **WD-202P customer display**

### **4.2 Parallel interface (connect to PC/Host)**

#### **4.2.1 Parallel interface specifications**

Data transmission	: 8-bit parallel
Synchronizing system	: According to the strobe pulses
Handshaking	: According to the BUSY signal
Signal level	: TTL level

#### **4.2.2 Parallel link to PC/Host (CN5)**

Type: DB25/M

Pin assignment

No.	Signal	I/O	Descriptions
13	STB-	Input	Strobe signal
12	DATA 1	Input	Input data
5	DATA 8	Input	Input data
4	ACK-	Output	Request for next data
3	BUSY	Output	Processing is busy
2	PE	Output	Paper end
24	FAULT-	Output	Printer error
22	RESET-	Input	Reset
14~20	GND	---	Ground

#### **4.2.3 Timing Chart**

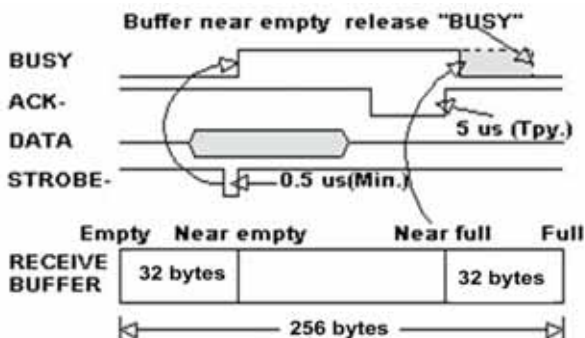



### 4.3 RS232C interface (Transfer to display)

#### 4.3.1 Specifications

<b>Data transmission:</b>	<b>Serial</b>
Synchronization:	Asynchronous
Handshaking:	DTR / DSR
Signal level:	MARK = -3 to -15 V (logic "1") SPACE = +3 to +15 V (logic "0")
Baud rates:	9600bps (fix)
Parity and bit length	None parity, 8 data bits
Stop bits:	1 or more

#### 4.3.2 RS232C link to display pannel (CN4)

Type: RJ45/10P/8C

Pin assignment

No	Signal	Direction	Function description
2,3	Vin	-	Power 9 – 35 Vdc
4,5	GND	-	Signal ground
6	DSR	To Display	Printer ready signal
7	DTR	-	Ready signal
8	RXD	To Display	Display/Printing data signal
9	TXD	To Printer	Printer status data signal



10 1

#### 4.3.3 Timing Chart

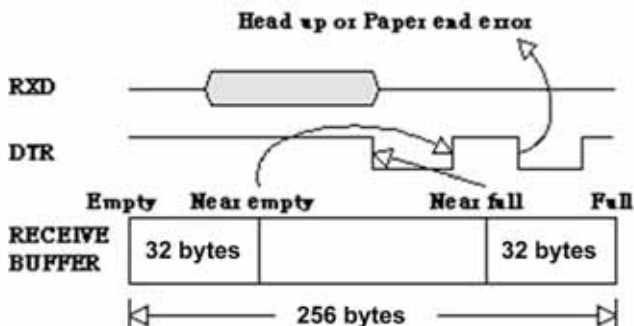

## ***WD-202P customer display***

### **4.4 RS232C interface (Pass through to printer)**

#### **4.4.1 Specifications**

Data transmission:	Serial
Synchronization:	Asynchronous
Handshaking:	DTR / DSR
Signal level:	MARK = -3 to -15 V (logic "1") SPACE = +3 to +15 V (logic "0")
Baud rates:	9600bps (fix)
Parity and bit length	None parity, 8 data bits
Stop bits:	1 or more

#### **4.4.2 RS232C link to printer connector (CN3)**

Type: DB9/M

Pin assignment

No	Signal	Direction	Function description
2	RXD		Printer status data
3	TXD	to printer	Printing data
5	GND	-	Signal ground
4,7	DTR	to printer	PC/Host ready signal
6	DSR	to display	Printer ready signal
9	Vin2	to printer	Power through to printer

#### **4.4.3 Timing Chart**

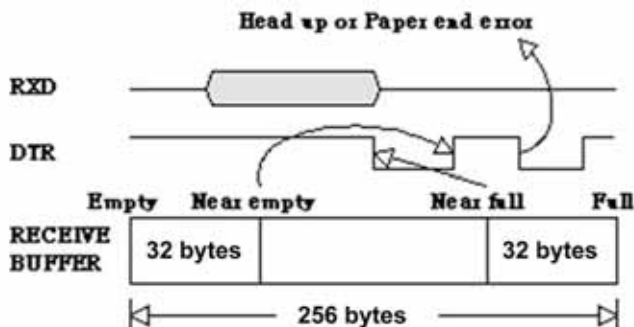

## 5. DIP SWITCH SETTING

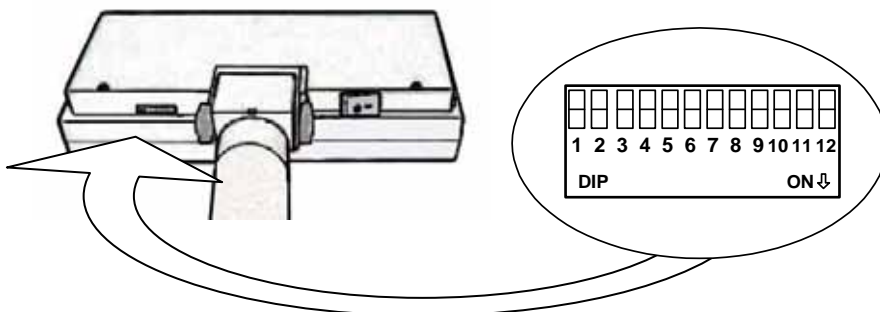

### 5.1 Command type selection

SW1	SW2	SW3	Command type
ON	ON	ON	DSP800
OFF	ON	ON	ESC/pos
ON	OFF	ON	ADM 787
OFF	OFF	ON	ADM 788
ON	ON	OFF	EMAX(Aedex)
OFF	ON	OFF	UTC/P
ON	OFF	OFF	UTC/S
OFF	OFF	OFF	CD5220

Table 5-1

### 5.2 Baud rate selection

SW8	SW9	Baud rate (bps)
OFF	ON	9600

Table 5-2

### 5.3 Parity check selection

SW10	Parrrity & data bites
ON	None-parity , 8 data bites

Table 5-3

**5.4 International character set selection**

SW4	SW5	SW6	SW7	Character set	Code table ( 80H-FFH)
ON	ON	ON	ON	U.S.A.	PC-437(USA&Europe)
OFF	ON	ON	ON	FRANCE	PC-858(Euro)
ON	OFF	ON	ON	GERMANY	PC-858(Euro)
OFF	OFF	ON	ON	U.K.	PC-858(Euro)
ON	ON	OFF	ON	DENMARK I	PC-858(Euro)
OFF	ON	OFF	ON	SWEDEN	PC-858(Euro)
ON	OFF	OFF	ON	ITALY	PC-858(Euro)
OFF	OFF	OFF	ON	SPAIN	PC-858(Euro)
ON	ON	ON	OFF	JAPAN	Katakana
OFF	ON	ON	OFF	NORWAY	PC-858(Euro)
ON	OFF	ON	OFF	DENMARK II	PC-858(Euro)
OFF	OFF	ON	OFF	U.S.A	Slavonic
ON	ON	OFF	OFF	U.S.A	Russia
OFF	ON	OFF	OFF	U.S.A	PC860 (Portuguese)
ON	OFF	OFF	OFF	U.K.	Greek
OFF	OFF	OFF	OFF	Not used	

Table 5-4

**5.5 Self-test & demo function selection**

SW11	Function
ON	Enable
OFF	Disable

Table 5-5

\* SW12 reseve

**6. COMMAND****6.1 CD5220 Standard Mode Command List**

<b>Command</b>	<b>Code (hex)</b>	<b>Function description</b>
ESC DC1	1B 11	Overwrite mode
ESC DC2	1B 12	Vertical scroll mode
ESC DC3	1B 13	Horizontal scroll mode
ESC QA ....CR	1B 51 41 <i>data</i> x m 0D	Set the string display mode, wrote string to upper line . m 20
ESC QB ....CR	1B 51 42 <i>data</i> x m 0D	Set the string display mode, wrote string to lower line . m 20
ESC QD ....CR	1B 51 44 <i>data</i> x m 0D	Upper line message scroll continuously . m 40
ESC [ D	1B 5B 44	Move cursor left
BS	08	Move cursor left
ESC [ C	1B 5B 43	Move cursor right
HT	09	Move cursor right
ESC [ A	1B 5B 41	Move cursor up
ESC [ B	1B 5B 42	Move cursor down
LF	0A	Move cursor down
ESC [ H	1B 5B 48	Move cursor to home position
HOM	0B	Move cursor to home position
ESC [ L	1B 5B 4C	Move cursor to left-most position
CR	0D	Move cursor to left-most position
ESC [ R	1B 5B 52	Move cursor to right-most position
ESC [ K	1B 5B 4B	Move cursor to bottom position
ESC I x y	1B 6C x y	Move cursor to specified position 1 x 20 ,row position 1 y 2 ,column position

## ***WD-202P customer display***

<b>Command</b>	<b>Code (hex)</b>	<b>Function description</b>
ESC @	1B 40	Initialize display
ESC W s x1 x2 y y	1B 57 1 x1 x2 y	Set or cancel the window range at horizontal scroll mode 1 x1 x2 20 , row position 1 y 2 , column position
CLR	0C	Clear display screen , and clear string mode
CAN	18	Clear cursor line, and clear string mode
ESC * n	1B 2A n	Brightness adjustment 1 n 4
ESC & s n m [a (P1..pa)]x (m-n+1)	1B 26 1 n m [a(p1..pa)]x (m-n+1)	Define download characters. 32 < n m 255 1 a 5 p1..p5 =row1..row5
ESC ?	1B 3F	Deletes download characters.
ESC %	1B 25	Select/cancel download character set.
ESC _ n	1B 5F n	Set cursor on/off .n = 1 , cursor off .n = 2 , cursor on
ESC f n	1B 66 n	Select international fonts set, refer *2
ESC c n	1B 63 n	Select code, refer *3
ESC = n	1B 3D n	Select peripheral device, display or printer .n bit 0 = 1 select printer .n bit 1 = 1 select display
ESC s 1	1B 73 01	Store the use define character into eeprom
ESC d 1	1B 64 01	Store the use define character from eeprom

Table 6-1

**\*2:** The parameter of international fonts set control by command **"ESC f n"**

<b>Parameter n</b>	<b>International Font Set</b>
"A"	U.S.A.
"G"	Germany
"I"	Italy
"J"	Japan
"U"	U.K.
"F"	France
"S"	Spain
"N"	Norway
"W"	Sweden
"D"	Denmark I
"E"	Denmark II
"L"	Slavonic
"R"	Russia

Table 6-2

**\*3:** The parameter of the code table control by command **"ESC c n"**

<b>Parameter "n"</b>	<b>International font set</b>
"A"	Compliance with ASCII code
"J"	Compliance with JIS code
"L"	Compliance with SLAVONIC code
"R"	Compliance with RUSSIA code

Table 6-3

**6.2 UTC standard mode command list**

<b>Command</b>	<b>Code (hex)</b>	<b>Function description</b>
BS	08	Back space
HT	09	Horizontal tab
LF	0A	Line feed
CR	0D	Carriage return
DLE	0F	Display position
DC1	11	Over write display mode
DC2	12	Vertical scroll mode
DC3	13	Cursor on
DC4	14	Cursor off
US	1F	Clear display
ESC d	1B 64	Change to UTC enhanced mode

Table 6-4

**6.3 UTC enhanced mode command list**

<b>Command</b>	<b>Code (hex)</b>	<b>Function description</b>
ESC u A ..CR	1B 75 41 <i>data</i> x m 0D	Upper line display 0      m      20
ESC u B ..CR	1B 75 42 <i>data</i> x m 0D	Bottom line display 0      m      20
ESC u D ..CR	1B 75 44 <i>data</i> x m 0D	Upper line message scroll continuously 0      m      40
ESC u E ..CR	1B 75 45 hh ':' mm 0D	Display time '00'      hh      '23' '00'      mm      '59'
ESC u F ..CR	1B 75 46 <i>data</i> x m 0D	Upper line message scroll once pass
ESC u H ..CR	1B 75 48 n m 0D	Change attention code 32      n      255 32      m      255
ESC u I ..CR	1B 75 49 <i>data</i> x m 0D	Two line display 0      m      40
ESC RS CR	1B 0F 0D	Change to UTC standard mode

Table 6-5



**6.4 AEDEX mode command list**

<b>Command</b>	<b>Code (hex)</b>	<b>Function description</b>
! # 1 ....CR	21 23 31 <i>data</i> x m 0D	Upper line display 0 m 40
! # 2 ....CR	21 23 32 <i>data</i> x m 0D	Bottom line display 0 m 40
! # 4 ....CR	21 23 34 <i>data</i> x m 0D	Upper line message scroll continuously 0 m 40
! # 5 ....CR	21 23 35 hh ':' mm 0D	Display time '00' hh '23' '00' mm '59'
! # 8 ....CR	21 23 38 n m 0D	Change attention code 32 n 255 32 m 255
! # 9 ....CR	21 23 39 <i>data</i> x m 0D	Two line display 0 m 40

Table 6-6

**6.5 ADM787/788 mode command list**

<b>Command</b>	<b>Code (hex)</b>	<b>Function description</b>
CLR	0C	Clear display
CR	0D	Carriage return
SLE1	0E	Clear up line and move cursor to upper line left most end
SLE2	0F	Clear low line and move cursor to lower line left most end
DC0	10 n	Set period to upper line last n position 31H n 37H
DC1	11 n	Set line blanking , .n = 31H up line .n = 32H low line
DC2	12 n	Clear line blanking , .n = 31H up line .n = 32H low line
SF1	1E	Clear field 1 and move cursor to field 1 fast position
SF2	1F	Clear field 2 and move cursor to field 2 fast position

Table 6-7

## ***WD-202P customer display***

### **6.6 DSP-800 mode command list**

<b>Command</b>	<b>Code (hex)</b>	<b>Function descriptions</b>
EOT SOH I n ETB	04 01 49 n 17	Select international character set.
EOT SOH P n ETB	04 01 50 n 17	Move cursor to specified position. 31H     n     58H
EOT SOH C n m ETB	04 01 43 n m 17	Clear display range from n position to m position and move cursor to n position. 31H     n     m     58H
EOT SOH S n ETB	04 01 53 n 17	Save the current displaying data to n layer for demo display. 31H     n     35H
EOT SOH D n m ETB	04 01 44 n m 17	Display the saved data 31H     n     4FH 31H     m     33H
EOT SOH A n ETB	04 01 41 n 17	Brightness adjustment. 31H     n     34H
EOT SOH F n ETB	04 01 46 n 17	Blink display screen. 0     n     255
EOT SOH & n [px5] ETB	04 01 26 n p1...p5 17	Define download characters 20H < n     FFH
EOT SOH ? n ETB	04 01 3F n 17	Delete download characters. 20H < n     FFH
EOT SOH = n ETB	04 01 3D n 17	Select peripheral device. .n = 31H,select printer .n = 32H,select display
EOT SOH % ETB	04 01 25 17	Initialize display
EOT SOH @ ETB	04 01 40 17	Execute self-test

Table 6-8

## ***WD-202P customer display***

### **6. 7 EPSON Esc/pos command list**

<b>Command</b>	<b>Code (hex)</b>	<b>Function description</b>
HT	09	Move cursor right.
BS	08	Move cursor left.
US LF	1F 0A	Move cursor up.
LF	0A	Move cursor down.
US CR	1F 0D	Move cursor to right-most position.
CR	0D	Move cursor to left-most position.
HOM	0B	Move cursor to home position.
US B	1F 42	Move cursor to bottom position.
US \$ x y	1F 24 x y	Move cursor to specified position. 1    x    20 1    y    2
CLR	0C	Clear display screen.
US X n	1F 58 n	Brightness adjustment. 1    n    4
US E n	1F 45 n	Blink display screen. 0    n    255
ESC @	1B 40	Initialize display.
ESC t n	1B 74 n	Select character code table. 0    n    14
ESC R n	1B 52 n	Select international character set. 0    n    14
US r n	1F 72 n	Select/cancel reverse character. 0    n    1
US MD1	1F 01	Specify overwrite mode.
US MD2	1F 02	Specify vertical scroll mode.
US MD3	1F 03	Specify horizontal scroll mode.
ESC & s n m [a(p1..pa)]x m-n	1B 26 1 n m [a(p1..pa)]x m-n	Define download characters. 32 < n        m        255 1    a        5 p1..p5 =row1..row5

## ***WD-202P customer display***

<b>Command</b>	<b>Code (hex)</b>	<b>Function description</b>
ESC ?	1B 3F	Delete downloads characters.
ESC %	1B 25	Select/cancel download character set.
ESC W n s x1 y1 x2 y2	1B 57 n s x1 y1 x2 y2	Specify/cancel the window range. 1 n 4 , 0 s 1 1 x1 x2 20 1 y1 y2 2
ESC = n	1B 3D n	Select peripheral device. .n bit 0 = 1 select printer .n bit 1 = 1 select display
US :	1F 3A	Set starting/ending position of macro definition.
US ^ n m	1F 5E n m	Execute and quit macro. 0 n 255 , 0 m 255
US @	1F 40	Execute self-test.
US T h m	1F 54 h m	Display time 0 h 23 , 0 m 59
US U	1F 55	Display time continuously
US V n	1F 56 n	Status confirmation by DTR signal 0 n 1

Table 6-9

## ***WD-202P customer display***

---

Select international font

.n	1F 40
0	U.S.A.
1	France
2	Germany
3	U.K.
4	Denmark I
5	Sweden
6	Italy
7	Spain
8	Japan
9	Norway
10	Denmark II
11	Slavonic
12	Russia
13	Portuguese
14	Greek
15	Reserved

Select code table

.n	Execute self-test.
0	Page 0,(PC437,USA standard Euro.)
1	Page 1,(Katakana for Japan)
2	Page 2,(PC850,Multilingual)
3	Page 3,(PC860, Portuguese)
4	Page 4,(PC863,Canadian-French)
5	Page 5,(PC865,Nordic)
6	Page 6,(Slavonic)
7	Page 7,(Russian)
19	Page 8,(PC858, Euro)
16	Page 9,(WPC1252.)
12	Page 12,(Greek)

## 7. CHARACTER SET

### 7.1 USA,standard character set (20h – 7Eh)

	00	01	02	03	04	05	06	07	08	09	0A	0B	0C	0D	0E	0F
20H	.....	..0.	.0.0.	0.0.	..0.	00..	..00.	00..	..0.	0.	.....	.....	.....	.....	.....	.....0
	.....	..0.	0.0.	0.0.	0000	00..0	0.0.	..0.	..0.	0.0.	0.0.0	0.	.....	.....	.....	.....0.
	.....	..0.	0.0.	00000	0.0.	..0.	0.0.	..0.	..0.	0.0.	0.0.0	00000	.....	00000	.....	.....0.
	.....	..0.	0.0.	0000	0.0.	000.	..0.	..0.	.....	0.0.	0.0.	0000	00000	.....	.....	.....0.
	.....	.....	00000	0.0.0	0.0.	0.0.0	.....	.....	0.0.	0.0.	0.0.0	0.0.	00.	.....	00.	.....0.
	.....	0.0.	0000.	0.000	0.00	0.0.	.....	.....	0.0.	0.0.	.....	0.0.	0.	.....	00.	0.0.
	.....	..0.	.....	0.0.	..0.	00.0	00.0	.....	..0.	0.	.....	0.	.....	00.	.....	00.
30H	0.00.	..0.	000.	00000	...0.	00000	..00.	00000	000.	000.	.....	.....	..0.	.....	0.0.	000.
	0...0	00.	0...0	0...0	0...0	0...0	0...0	0...0	0...0	0...0	00.	00.	0...0	.....	0...0	0...0
	0.00	0.0.	.....	0.0.	0.0.	0000.	.....	0.0.	0.0	0.0	00.	00.	0.0.	00000	0.0.	0...0
	0.0.0	0.0.	.....	0.0.	0.0.	.....	0.0000.	.....	0.0.	0000	0000	.....	0.0.	.....	0.0.	0.0.
	00..0	0.0.	.....	0.0.	0.00000	0.0.0	0.0.0	0.0.	0.0.	0.0	00.	00.	0.0.	00000	0.0.	0.0.
	0.0.0	0.0.	0.0.0	0.0.0	0.0.0	0.0.0	0.0.0	0.0.	0.0.	0.0	00.	0.0.	0.0.	0.0.	0.0.	0.0.
	0.00.	000.	00000	000.	...0.	000.	000.	0.0.	000.	00.	.....	0.0.	0.0.	.....	0.0.	0.0.
40H	0.00.	..0.	0000.	000.	000.	00000	00000	000.	0.0.	0.000.	0000	0.0.0	0.0.	0.0.0	0.0.	000.
	0...0	0.0.	0.0.0	0.0.0	0.0.0	0.0.0	0.0.0	0.0.0	0.0.0	0.0.	0.0.	0.0.	0.0.	00.00	0.0.	0.0.0
	0.000	0.0.0	0.0.0	0.0.0	0.0.0	0.0.0	0.0.0	0.0.0	0.0.0	0.0.	0.0.	0.0.	0.0.	0.0.0	00.0	0.0.0
	00.00	0.0.0	0000.	0.0.	0.0.0	0000.	0000.	0.000	00000	0.0.	00.	0.0.	0.0.	0.0.0	0.0.0	0.0.0
	0.000	00000	0.0.0	0.0.	0.0.0	0.0.0	0.0.0	0.0.0	0.0.0	0.0.	0.0.	0.0.	0.0.	0.0.0	0.00	0.0.0
	0.0.0	0.0.	0.0.0	0.0.0	0.0.0	0.0.0	0.0.0	0.0.0	0.0.0	0.0.	0.0.	0.0.	0.0.	0.0.0	0.0.0	0.0.0
	0.000	0.0.0	0000.	000.	000.	00000	0.0.	0000	0.0.0	000.	00.	0.0.	0.0.	00000	0.0.0	0.00.
50H	0000.	000.	0000.	000.	00000	0.0.0	0.0.0	0.0.0	0.0.0	0.0.0	00000	000.	.....	000.	..0.	.....
	0...0	0.0.0	0.0.0	0.0.0	0.0.0	0.0.0	0.0.0	0.0.0	0.0.0	0.0.0	0...0	0.0.	0.0.	0.0.	0.0.	.....
	0...0	0.0.0	0.0.0	0.0.	0.0.	0.0.0	0.0.0	0.0.0	0.0.	0.0.	0.0.	0.0.	0.0.	0.0.	0.0.	0.0.
	0000.	0.0.0	0000.	000.	0.0.	0.0.0	0.0.0	0.0.0	0.0.	0.0.	0.0.	0.0.	0.0.	0.0.	0.0.	0.0.
	0.0.0	0.0.0	0.0.	.....	0.0.	0.0.0	0.0.0	0.0.0	0.0.0	0.0.	0.0.	0.0.	0.0.	0.0.	0.0.	0.0.
	0.0.0	0.0.	0.0.0	0.0.0	0.0.0	0.0.0	0.0.0	0.0.0	0.0.0	0.0.	0.0.	0.0.	0.0.	0.0.	0.0.	0.0.
	0.0.0	00.0	0.0.0	0.0.	0.0.0	0.0.	0.0.	0.0.0	0.0.0	0.0.	0.0.	0.0.	0.0.	0.0.	0.0.	0.0.
	0.0.0	0.0.0	0.000.	000.	0.0.	0000	0.0.	0000	0.0.0	0.0.	0.0.	0.0.	0.0.	0.0.	0.0.	00000
60H	..0.	.....	0.0.	.....	...0	.....	..0.	.....	0.0.	..0.	..0.	0.0.	00.	.....	.....	.....
	..0.	.....	0.0.	.....	...0	.....	..0.	.....	0.0.	..0.	..0.	0.0.	0.0.	.....	.....	.....
	.....	000.	0000.	0000	0000	000.	0.0.	0000	0000.	00.	0.0.	0.0.	0.0.	00.00	0.00.	000.
	.....	0.0.0	0.0.0	0.0.	0.0.0	0.0.0	000.	0.0.0	0.0.0	0.0.	0.0.	0.0.	0.0.	0.0.0	00.0	0.0.0
	.....	0000	0.0.0	0.0.	0.0.0	00000	0.0.	0000	0.0.0	0.0.	00.	0.0.	0.0.	0.0.0	0.0.0	0.0.0
	.....	0.0.0	0.0.0	0.0.	0.0.0	0.0.	.....	0.0.0	0.0.0	0.0.	0.0.	0.0.	0.0.	0.0.0	0.0.0	0.0.0
	.....	0000	0000.	0000	0000	000.	..0.	0000.	0.0.0	000.	00.	0.0.	0.0.	000.	0.0.0	0.00.
70H	.....	.....	.....	.....	..0.	.....	.....	.....	.....	.....	.....	..00.	0.0.	00.	00.0	..0.
	.....	.....	.....	.....	..0.	.....	.....	.....	.....	.....	.....	0.0.	0.0.	..0.	0.00.	0.0.
	0000.	0000	0.00.	0000	00000	0.0.0	0.0.0	0.0.0	0.0.0	0.0.0	00000	0.0.	0.0.	..0.	.....	0.0.0
	0.0.0	0.0.0	00.0	0.0.	0.0.0	0.0.0	0.0.0	0.0.0	0.0.0	0.0.0	0.0.0	0.0.	0.0.	.....	0.0.	0.0.0
	0000.	0000	0.0.	000.	0.0.	0.0.0	0.0.0	0.0.0	0.0.	0000	0.0.	0.0.	0.0.	.....	00000	.....
	0.0.0	0.0.0	0.0.	.....	0.0.0	0.0.0	0.0.0	0.0.0	0.0.	0.0.	0.0.	0.0.	0.0.	.....	0.0.	.....
	0.0.0	0.0.0	0.0.	0000.	...0.	000.	..0.	0.0.	0.0.	0.0000.	00000	..00.	0.0.	00.	.....	.....

Table 7-1

## 7.2 Internation Character Sets

[illegible]

Table 7-2

# WD-202P customer display

## 7.3 Page 0 (PC437: USA, Standard Europe) (80H – FFH)

	00	01	02	03	04	05	06	07	08	09	0A	0B	0C	0D	0E	0F
80H	.0000	....	..0.	.0.	.0.0.	.0.	.0.	....	.0.	.0.0.	.0.	.0.0.	.0.	.0.	.0.	.0.
	0....	.0.0.	..0.	.0.0.	....	.0.	.0.0.	0000	.0.0.	....	.0.	....	.0.0.	....	.0.	.0.0.
	0....	....	000.	000.	000.	....	0....	000.	000.	0....	....	....	....	....	000.	....
	0....	0..0	0..0	....0	....0	....0	0000	0....	0..0	0..0	0..0	0..0	....	....	000.	0..0
	0000	0..0	00000	0000	0000	0000	0000	00000	00000	00000	00000	....	....	....	00000	0..0
	..0.	0.00	0....	0..0	0..0	0..0	0..0	0....	0....	0....	....	....	....	....	0..0	00000
	0....	00.0	000.	0000	0000	0000	0000	0....	0000	0000	0000	....	....	....	000.	0..0
90H	....0.	....	0000	..0.	.0.0.	.0.	.0.	....	.0.0.	.0.0.	.0.0.	....	....	000.	0..0	0000
	..0.	....	0.0.	.0.0.	....	....	.0.0.	....	....	....	....	....	....	0..0	0.0.	0..0
	00000	00.0.	0.0.	....	....	....	....	....	0..0	000.	0..0	0000	0..0.	....	0000.	....
	0....	..0.0	0.000	0000.	0000.	0000.	0..0	0..0	0..0	0..0	0..0	0..0	0000.	00000	0..0.	0000.
	0000.	00000	000.	0..0	0..0	0..0	0..0	0..0	0..0	0..0	0..0	0..0	....	....	0..0	0000
	0....	0.0.	0.0.	0..0	0..0	0..0	0..0	000	0..0	0..0	0..0	0..0	00000	0..0.	00000	0..0.
	00000	00.00	0.000	000.	000.	000.	000.	000.0	000.0	0000.	000.	000.	00000	0..0.	0..0	0..0
A0H	....0.	....0.	....0.	....0.	00.0	00.0	000.	000.	..0.	....	....	0.0.	0.0.	....	..0.	0..0
	..0.	..0.	..0.	..0.	000.	000.	....0	0..0	....	....	....	0.0.	0.0.	....	..0.0	0..0.
	000.	....	....	....	0000	0..0	0..0	00000	0000	0000	000.	0..0	....	....	0.0.	0..0.
	....0	00.	000.	0..0	000.	00.0	0..0	0..0	0..0	0..0	0..0	000.	000	....	0..0.	0..0
	0000	..0.	0..0	0..0	00.0	00.0	00.0	0000	000.	....	....	0..0	0..0	....	0..0.	0..0
	0..0	0..0.	0..0.	000	0..0	0..0	0..0	0000	0..0	....	....	0..0	0..0	....	0..0	0..0
	0000	000.	000.	000	0..0	0..0	0..0	00000	0000	000.	....	0000	0..0	....	0..0	0..0
B0H	.0.0.	0.0.0	00000	..0.	..0.	..0.	.0.0.	....	....	.0.0.	.0.0.	....	.0.0.	.0.0.	..0.	....
	0.0.0	0.0.0	00000	..0.	..0.	..0.	.0.0.	....	....	.0.0.	.0.0.	....	.0.0.	.0.0.	..0.	....
	0.0.	0.0.0	00000	..0.	000.	000.	.0.0.	....	000.	00.0.	0.0.	0000.	00.0.	0.0.	000.	....
	0.0.0	0.0.0	00000	..0.	000.	000.	.0.0.	0000.	..0.	..0.	0.0.	....	0..0.	0000.	0..0.	000.
	0.0.	0.0.0	00000	..0.	000.	000.	.0.0.	000.	00.0.	00.0.	00.0.	000.	0000.	000.	000.	..0.
	0.0.0	0.0.0	00000	..0.	0..0.	0..0.	.0.0.	0..0.	0..0.	0..0.	0..0.	0..0.	....	....	....	..0.
	0.0.0	0.0.0	00000	..0.	0..0.	0..0.	.0.0.	0..0.	0..0.	0..0.	0..0.	0..0.	....	....	....	..0.
C0H	..0.	..0.	....	..0.	....	..0.	..0.	.0.0.	.0.0.	....	.0.0.	....	.0.0.	....	.0.0.	..0.
	..0.	..0.	....	..0.	....	..0.	..0.	.0.0.	.0.0.	....	.0.0.	....	.0.0.	....	.0.0.	..0.
	..0.	..0.	....	..0.	....	..0.	..0.	000	0..0.	000	00.00	00000	00.00	00000	00.00	00000
	..000	00000	00000	..000	00000	00000	0..0	00.00	0..0.	....	....	....	....	....	....	....
	....	....	..0.	....	....	..0.	0000	0..0.	00000	0..00	00000	00.00	00000	00.00	00000	00000
	....	....	..0.	....	....	..0.	0..0.	0..0.	....	....	....	0.0.	0.0.	....	0..0.	....
	....	....	..0.	....	....	..0.	0..0.	0..0.	....	....	....	0.0.	0.0.	....	0..0.	....
D0H	.0.0.	....	....	.0.0.	..0.	....	....	.0.0.	..0.	..0.	....	00000	....	000.	..000	00000
	.0.0.	....	....	.0.0.	..0.	....	....	.0.0.	..0.	..0.	....	00000	....	000.	..000	00000
	.0.0.	00000	....	.0.0.	0000	0000	0000	.0.0.	00000	..0.	....	00000	....	000.	..000	00000
	00000	00000	00000	0000	..0.	..0.	.0.0.	00000	..0.	000.	..000	00000	00000	0000.	..000	00000
	00000	00000	0.0.	....	0000	0000	.0.0.	.0.0.	00000	....	..0.	00000	00000	000.	..000	....
	....	..0.	0.0.	....	....	..0.	0..0.	0..0.	....	....	..0.	00000	00000	000.	..000	....
	....	..0.	0.0.	....	....	..0.	0..0.	0..0.	....	....	..0.	00000	00000	000.	..000	....
E0H	....0	..00.	00000	00000	00000	0000	....	....	000.	0000.	000.	0000	....	....	0	000.
	....0	0..0	0..0	0..0.	0..0.	0..0	0..0	....	000.	0..0	0..0	0..0	....	0..0.	0..0	0..0
	00.0	0000.	0....	0.0.	..0.	0.0.	0..0	00000	0.0.0	0..0	0..0	0..0	....	0.0.0	0000.	0..0
	0.0.	0..0	0..0	....	0.0.	..0.	0.0.	0..0	0..0	00000	0..0	0000.	0..0.	0.0.0	0000.	0..0
	0.0.	0..0	0..0	....	0.0.	..0.	0.0.	000.0	0..0.	0..0	0..0	0..0	....	0.0.0	0..0	0..0
	0.0.0	0000.	0....	0.0.	0..0	0..0	0..0	....	0000.	0..0	0..0	0..0	....	0000.	0..0	0..0
	00..0	00..	0....	0.00	00000	00..	0....	..00.	0000.	0000.	00.00	0000.	....	0....	0000.	0..0
F0H	00000	....	0....	....0	..0.	..0.	....	00.0	0000.	....	....	0000	0.0.	..00.	....	....
	....	..0.	0..0.	0..0.	0..0	0..0.	....	0..0.	000.	....	....	0000	0..0.	0..0	000.	....
	00000	0000	0..0.	0..0.	0..0.	0..0.	....	0000	00.0	....	..0.	0..0.	0..0	0..0.	000.	....
	....	..0.	00000	00000	0..0.	0..0.	....	000.	....	....	....	0..0.	....	0000	000.	....
	....	..0.	00000	00000	0..0.	0..0.	....	....	....	....	....	00.	....	000.	000.	....
	00000	00000	00000	00000	0..0.	0..0.	....	....	....	....	....	0..0.	....	....	....	....

Table 7-3





# WD-202P customer display

## 7.5 Page 2 (PC850: Multilingual) (80H – FFH)

	00	01	02	03	04	05	06	07	08	09	0A	0B	0C	0D	0E	0F
80H	.0000	.0.0.	...0.	..0.	.0.0.	..0.	..0.	..0.	..0.	..0.	..0.	..0.	..0.	..0.	..0.	..0.
	0....	...0.	..0.	..0.	..0.	..0.	..0.	0000	..0.	..0.	..0.	..0.	..0.	..0.	..0.	..0.
	0....	0..0	000.	000.	000.	000.	000.	000.	000.	000.	000.	000.	000.	000.	000.	000.
	0....	0..0	0..0	0..0	0..0	0..0	0..0	0000	0....	0..0	0..0	0..0	0..0	0..0	0..0	000.
	0000	0..0	00000	0000	0000	0000	0000	0000	0000	0000	0000	0000	0000	0000	0000	0..0
	..0.	0.00	0....	0..0	0..0	0..0	0..0	0..0	0....	0....	0....	0....	0....	0....	0..0	00000
	..0.	..0.	0000	0000	0000	0000	0000	0....	0000	0000	..0.	..0.	..0.	0000	0..0	0..0
90H	..0.	..0.	0000	..0.	..0.	..0.	..0.	..0.	..0.	..0.	..0.	..0.	..0.	..0.	..0.	..0.
	..0.	..0.	0..0.	0..0.	..0.	..0.	..0.	..0.	..0.	..0.	..0.	..0.	..0.	..0.	..0.	..0.
	00000	00.0.	0..0.	..0.	..0.	..0.	..0.	..0.	0..0	000.	0..0	000.	0..0	000.	0..0	0..0
	0....	0..0	0000	0000	0000	0000	0..0	0..0	0..0	0..0	0..0	0..0	0000	0..0	..0.	0000.
	0000.	00000	000.	0..0	0..0	0..0	0..0	0..0	0000	0..0	0..0	0..0	0..0	0..0	0..0	0..0
	0....	0..0.	0..0.	0..0	0..0	0..0	0..0	000	0..0	0..0	0..0	0..0	0..0	0..0	0..0	0..0
	00000	00.00	00.00	0000	0000	0000	0000	0000	0000	0000	0000	0000	0000	0000	0....	0..0
A0H	..0.	..0.	..0.	..0.	00.0	00.0	000.	000.	..0.	000.	....	0..0.	0..0.	..0.	..0.	0..0
	..0.	..0.	..0.	..0.	00.0	00.0	....	0..0	000.	000.	0..0.	0..0.	0..0.	..0.	..0.	0..0
	000.	000.	000.	000.	000.	000.	000.	0..0	0..0	000	000000	00..	0..0	0..0	0..0	0..0
	..0.	0..0.	000.	0..0	00.0	00.0	0..0	0..0	0..0	000.	0..0	0..0	0..0	0..0	0..0	0..0
	0000	..0.	0..0	0..0	00.0	00.0	0..0	0000	000.	000.	0..0	0..0	0..0	0..0	0..0	0..0
	0..0	0..0.	0..0.	0..0	00.0	00.0	0..0	000	0..0	000	....	0..0	0000	0..0	0..0	0..0
	0000	000.	000.	0..0	0..0	0..0	000000	0000	000.	000.	....	0000	0..0	0..0	0..0	0..0
B0H	..0.	0..0	0..0	00000	..0.	..0.	..0.	..0.	000.	0..0.	0..0.	....	0..0.	..0.	0..0	....
	0..0.	0..0.	00000	0..0.	..0.	..0.	..0.	..0.	0..0	0..0.	0..0.	....	0..0.	0000	0..0.	....
	0..0.	0..0.	00000	0..0.	..0.	..0.	..0.	..0.	0000	00.0	0..0.	0000.	00.0.	0000.	0..0.	....
	0..0.	0..0.	00000	0..0.	000.	000.	000.	000.	00.0	0..0.	0..0.	....	0..0.	00000	000.	....
	0..0.	0..0.	00000	0..0.	..0.	..0.	..0.	..0.	0000	00.0	0000	00.0.	0000.	0..0.	00000	000.
	0..0.	0..0.	00000	0..0.	00000	00000	00000	0000	0..0.	0..0.	0..0.	0..0.	0..0.	0000	00000	0..0.
	0..0.	0..0.	00000	0..0.	0..0.	0..0.	0..0	0..0.	000.	0..0.	0..0.	0..0.	0..0.	....	0..0.	0..0.
C0H	..0.	..0.	....	..0.	....	..0.	00.0	00.0	0..0.	....	0..0.	....	0..0.	....	0..0.	0..0
	..0.	..0.	....	..0.	....	..0.	00.0	00.0	0..0.	....	0..0.	....	0..0.	....	0..0.	000.
	..0.	..0.	....	..0.	....	..0.	00.0	00.0	0..0.	0000	00.00	00000	0..00	00000	00.00	0..0
	000	00000	00000	0000	00000	00000	00000	0000	0000	0000	0000	0000	0000	0000	0000	0..0
	....	....	..0.	0..0.	....	0..0.	00.0	0..0	0000	0..00	00000	00.00	00000	00.00	00000	00.00
	....	....	..0.	0..0.	....	0..0.	00000	00000	0..0.	0..0.	0..0.	0..0.	0..0.	0..0.	0..0.	0000.
	....	....	..0.	0..0.	....	0..0.	0000	0..0	....	0..0.	....	0..0.	0..0.	....	0..0.	0..0
D0H	..0.	0000.	0..0.	0..0.	..0.	00.	..0.	..0.	....	0..0.	....	00000	....	..0.	0..0	00000
	000.	..0.	0..0.	..0.	..0.	00.	..0.	..0.	0..0.	..0.	....	00000	....	..0.	0..0	00000
	..0.	0..0.	00000	00000	00000	0..0.	000.	000.	000.	000.	0..0.	00000	....	..0.	00000	00000
	000.	000.	0..0	0....	0..0.	000.	000.	000.	000.	000.	0000	00000	00000	0000	0000	00000
	0..0	0..0.	0000.	0000.	0000.	0..0.	0..0.	0..0.	0..0.	0..0.	00000	00000	0..0.	0..0.	....	....
	0..0	0..0.	0..0	0....	0..0.	0..0.	0..0.	0..0.	0..0.	0..0.	00000	00000	0..0.	0..0.	....	....
	000.	0000.	00000	00000	00000	0000	000.	000.	000.	000.	....	0..0.	00000	00000	..0.	000.
E0H	..0.	..00.	..0.	0..0.	00.0	00.0	0..0	0..0.	000.	..0.	0..0.	0..0.	..0.	..0.	00000	..0.
	..0.	0..0	0..0.	..0.	00.0	00.0	0..0	0..0.	000.	000.	0..0.	0..0.	0..0.	0..0.	00000	..0.
	000.	000.	000.	000.	000.	000.	0..0	0..0	0..0	0..0	0..0	0..0	0..0	0..0	00000	..0.
	0..0	0..0.	000.	0..0	000.	000.	000.	000.	0..0	0..0	0..0	0..0	0..0	0..0	00000	..0.
	0..0	000.	0..0	0..0	0..0	0..0	0..0	0..0	000.	000.	0..0	0..0	0..0	0..0	00000	..0.
	0..0	0000.	0..0	0..0	0..0	0..0	0..0	0..0	0..0	0..0	0..0	0..0	0..0	0..0	00000	..0.
	000.	00..	000.	000.	000.	000.	0....	0..0	000.	000.	000.	000.	0000.	0000.	0..0.	....
F0H	00000	....	....	00..	0000	000.	....	....	000.	0..0.	....	..0.	000.	000.	....	....
	....	..0.	....	00.0	0..0.	0..0.	..0.	....	0..0.	....	....	00..	0..0	0..0	000.	....
	....	0..0.	00000	000.	0..0.	000.	000.	000.	000.	....	....	00..	0..0	0..0	000.	....
	00000	00000	0..0.	0..0.	0..0	00000	000.	....	....	....	....	00..	0..0	0..0	000.	....
	....	..0.	00000	00.00	0..0.	0..0.	0..0	....	....	....	....	000.	000.	0000	000.	....
	....	0..0.	00000	00.0	0..0.	0..0.	0..0	....	....	....	....	000.	000.	0000	000.	....
	....	00000	....	0..0.	0..0.	000.	....	....	....	....	....	000.	000.	0000	000.	....

Table 7-5

# WD-202P customer display

## 7.6 Page 3 (PC860: Portuguese) (80H – FFH)

	00	01	02	03	04	05	06	07	08	09	0A	0B	0C	0D	0E	0F
80H	.0000	.0.0.	...0.	.0.0.	.0.0.	.0...0.	.....	.0.	.0.0.	.0.0.	.0.0.	.0.0.	.0.0.	.0.0.	.0.0.	.0.0.
	0....	...0.	...0.	.0.0.	...0.	...0.	.0000	.0.0.	.0.0.	.0.0.	...0.	.0.0.	.0.0.	.0.0.	.0.0.	.0.0.
	0....	.0.0	.000.	.000.	.000.	.000.	.000.	0....	.000.	.0000	.000.	.000.	.000.	.....	.000.	.0.0.
	0....	.0.0	0.0.0	0.0.0	0.0.0	0.0.0	0.0.0	0.0.0	0.0.0	0.0.0	0.0.0	0.0.0	0.0.0	0.0.0	0.0.0	0.0.0
	.0000	0.0.0	00000	00000	00000	00000	00000	00000	00000	00000	00000	00000	0.0.0	0.0.0	0.0000	0.0.0
	.0.0.	0.00	0.000	0.0.0	0.0.0	0.0.0	0.0.0	0.0.	0.0.	0.0.	0.0.	0.0.	0.0.	0.0.	0.0.0	00000
	.0.0.	0.0.0	00000	00000	00000	00000	0.0.0	0.0.	0.0.	00000	000.	000.	000.	000.	0.0.0	0.0.0
90H	.0.0.	.0.0.	.0.0.	.0.0.	.....	.0.0.	.0.0.	.0.0.	.0.0.	.....	.0.0.	.0.0.	.....	.0.0.	.0.0.	.0.0.
	00000	.000.	00000	.....	.....	.0.0.	.....	.000.	.000.	0.0.0	00000	0.0.0	0.0.0	00000	.000.	.000.
	0....	.0.0	0.0...	.000.	.000.	.000.	.0.0	0.0.0	0.0.0	0.0.0	0.0.0	0.0.0	0.0.0	00000	0.0.0	0.0.0
	00000	00000	00000	0.0.0	0.0.0	0.0.0	0.0.0	0.0.0	0.0.0	0.0.0	0.0.0	0.0.0	0.0.0	0.0.0	0.0000	0.0.0
	0....	.0.0	0.0.0	0.0.0	0.0.0	0.0.0	0.0.0	0.0.0	0.0.0	0.0.0	0.0000	0.0.0	0.0.0	0.0.0	0.0.0	0.0.0
	00000	0.0.0	00000	.000.	.000.	.000.	.000.	.00.0	0.000.	.000.	.000.	.000.	00000	.000.	0.00	0000.
A0H	...0.	...0.	...0.	...0.	.00.0	.00.0	.000.	.000.	.0.0.	.0.0.	.....	0.0.0	0.0.0	.0.0.	...0.	.0.0.
	.0.0.	.0.0.	.0.0.	.0.0.	0.00.	0.00.	.....	0.0.0	.....	.0.0.	.....	0.0.0	0.0.0.	.....	.0.0	0.0.
	.000.	.....	.....	.....	.....	.....	00000	0.0.0	.0.0.	.000.	.....	00.0.	0.0.0	.0.0.	.0.0.	.0.0.
	.0.0.	.0.0.	.000.	0.0.0	0.00.	.00.0	0.0.0	0.0.0	0.0.0	0.0000	0.00.	0.00.	0.00.	0.0.0.	0.0.0.	0.0.0
	00000	.0.0.	0.0.0	0.0.0	0.0.0	0.0.0	0.0.0	0.0.0	0.0.0	0.0.0	0.0.0	0.0.0	0.0.0	0.0.0	0.0.0	0.0.0
	0.0.0	0.0.0	0.0.0	0.0.0	0.0.0	0.0.0	0.0.0	0.0.0	0.0.0	0.0.0	0.0.0	0.0.0	0.0.0	0.0.0	0.0.0	0.0.0
	00000	.000.	.000.	0.0.0	0.0.0	0.0.0	00000	00000	.000.	.....	0.0000	0.0.0	0.0000	0.0.0.	0.0.0.	.0.0.
B0H	.0.0.	0.0.0	00000	.0.0.	.0.0.	.0.0.	.0.0.	.....	.0.0.	.0.0.	.....	.0.0.	.0.0.	.0.0.	.0.0.	.....
	0.0.0	0.0.0	00000	.0.0.	.0.0.	.0.0.	.0.0.	.....	.0.0.	.0.0.	.....	.0.0.	.0.0.	.0.0.	.0.0.	.....
	0.0.0	0.0.0	00000	.0.0.	.0.0.	.000.	.0.0.	.....	.000.	00.0.	0.0.0	00000.	00.0.	0.0.0.	0.0.0.	.....
	0.0.0	0.0.0	00000	.0.0.	.000.	.0.0.	00.0.	00000.	.0.0.	.0.0.	0.0.0.	.0.0.	0.0.0.	0.0.0.	0.0.0.	0000.
	0.0.0	0.0.0	00000	.0.0.	.000.	.0.0.	0.0.0.	0000.	00.0.	0.0.0	00.0.	00.0.	00.0.	0000.	.000.	.0.0.
	0.0.0	0.0.0	00000	.0.0.	.0.0.	.0.0.	0.0.0.	0.0.0.	0.0.0.	0.0.0.	0.0.0.	0.0.0.	0.0.0.	.....	0.0.	.0.0.
	0.0.0	0.0.0	00000	.0.0.	.0.0.	.0.0.	0.0.0.	0.0.0.	0.0.0.	0.0.0.	0.0.0.	0.0.0.	0.0.0.	.....	0.0.	.0.0.
C0H	.0.0.	.0.0.	.....	.0.0.	.....	.0.0.	.0.0.	.0.0.	.....	.0.0.	.....	.0.0.	.....	.0.0.	.0.0.	.0.0.
	.0.0.	.0.0.	.....	.0.0.	.....	.0.0.	.0.0.	.0.0.	.....	.0.0.	.....	.0.0.	.....	.0.0.	.0.0.	.0.0.
	.0.0.	.0.0.	.....	.0.0.	.....	.0.0.	.0.0.	.0.0.	.....	.0.0.	.....	.0.0.	.....	.0.0.	.0.0.	.0.0.
	.000	00000	00000	.000	00000	00000	.0.0.	0.00	0.0.0	00000	00.00	00000	.0.00	00000	00.00	00000
	.....	.....	.0.0.	.0.0.	.....	.0.0.	.0.0.	.....	.0.0.	.....	.0.0.	.....	.0.0.	.....	.0.0.	.....
	.....	.....	.0.0.	.0.0.	.....	.0.0.	.0.0.	.....	.0.0.	.....	.0.0.	.....	.0.0.	.....	.0.0.	.....
	.....	.....	.0.0.	.0.0.	.....	.0.0.	.0.0.	.....	.0.0.	.....	.0.0.	.....	.0.0.	.....	.0.0.	.....
D0H	.0.0.	.....	.....	.0.0.	.0.0.	.....	.0.0.	.0.0.	.0.0.	.....	00000	.....	000.	.000	00000	00000
	.0.0.	.....	.....	.0.0.	.0.0.	.....	.0.0.	.0.0.	.0.0.	.....	00000	.....	000.	.000	00000	00000
	.0.0.	00000	.....	.0.0.	.000	.000	00000	.0.0.	00000	.0.0.	00000	.....	00000	.....	.000	00000
	00000	.....	00000	00000	.0.0.	.0.0.	0.0.0	00000	.0.0.	00000	.0.000	.....	00000	00000	00000	00000
	.....	00000	.0.0.	.....	.000	.000	0.0.0.	0.0.0.	00000	.....	.0.0.	00000	00000	000.	.000	.....
	.....	.0.0.	0.0.0.	.....	.0.0.	.0.0.	0.0.0.	0.0.0.	0.0.0.	.....	.0.0.	00000	00000	000.	.000	.....
	.....	.0.0.	0.0.0.	.....	.0.0.	.0.0.	0.0.0.	0.0.0.	0.0.0.	.....	.0.0.	00000	00000	000.	.000	.....
E0H	...0.	.0.0.	00000	00000	00000	.000	.....	.....	.000.	.000.	.000.	.0000	.....	.0.0.	0.000.	.000.
	.0.0	0.0.0	0.0.0	0.0.0.	0.0.0.	0.0.0.	0.0.0.	0.0.	00000	0.0.0	0.0.0	0.0.0.	0.0.0.	0.0.0.	0.0.0.	0.0.0.
	.00.0	0.000.	0.0.0.	.0.0.	.0.0.	0.0.0.	0.0.0	000000	0.0.0	0.0.0	0.0.0.	0.0.0.	0.0.0.	0.000.	0.0.0.	0.0.0.
	0.0.0.	0.0.0	0.0.0.	.0.0.	.0.0.	0.0.0.	0.0.0	0.0.	0.0.0	000000	0.0.0.	0000.	0.0.0.	0.0.0	00000.	0.0.0.
	0.0.0.	0.0.0	0.0.0.	.0.0.	.0.0.	0.0.0	000.0	0.0.0.	0.0.0	0.0.0	0.0.0	0.0.0.	0.0.0.	0.0.0	0.0.0	0.0.0.
	0.0.0	0.000.	0.0.0.	.0.0.	0.0.0	0.0.0.	0.0.0.	0.0.0.	0.0.0.	0.0.0	0.0.0.	0.0.0.	0.0.0.	0000.	0.0.0.	0.0.0.
	00.0	0.00.	0.0.0.	0.0.0	00000	.00.	0.0.0.	.000.	.000.	.000.	00.00	0000.	.....	0.0.0.	0000.	0.0.0.
F0H	00000	.....	0.0.0.	...0.	.0.0.	.0.0.	.00.0	.000.	.....	.....	.....	.0000	.0.0.	.0.0.	.....	.....
	.....	.0.0.	.0.0.	.0.0.	.0.0.	.0.0.	.0.0.	0.00.	.0.0.	.....	.....	.000.	.00.0.	0.0.0	0000.	.....
	.....	.0.0.	.0.0.	.0.0.	.0.0.	.0.0.	.....	.....	.....	.....	.....	.00.	.0.0.	0.0.0	0000.	.....
	00000	00000	.0.0.	.0.0.	.0.0.	00000	.00.0	.....	.....	.....	.....	.0.0.	.0.0.	0.0.0	0000.	.....
	.....	.0.0.	00000	00000	.0.0.	0.0.0.	.....	.....	.....	.....	.....	.0.0.	.....	0000	0000.	.....
	00000	00000	00000	00000	.0.0.	0.0.0.	.....	.....	.....	.....	.....	.0.0.	.....	0000	0000.	.....

Table 7-6

# WD-202P customer display

## 7.7 Page 4 (PC863: Canadian-French) (80H – FFH)

	00	01	02	03	04	05	06	07	08	09	0A	0B	0C	0D	0E	0F
80H	.0000	.0.0.	...0.	..0.	..0.	..0.	.000.	.....	.0.	.0.0.	.0...	.0.0.	.0.	.....	.0.0.	.000.
	0.....	...0.	..0.	..0.	..0.	..0.	00.0.	.0000	.0.0.	.000.	.0.	.000.	.000.	.00.	.....	.000.
	0....	0..0	.000.	.000.	.000.	.000.	.0.0.	0....	.000.	.000.	.000.	.000.	.....	00000	.000.	.000.
	0....	0..0	0....0	0....0	0....0	0....0	.0.0.	0....	0....0	0....0	0....0	0....0	.00.	.....	0....0	0....0
	.0000	0.0	00000	.0000	00000	.0000	.0.0.	.0000	00000	00000	.0.	.0000	.0000	.0000	00000	.000.
	..0.	0..00	0....	0....0	0....0	0....0	.0.0.	.0.	0....	0....	00000	.0.	.0.	.0000	00000	0....0
	..0.	00.0	.0000	.0000	0....0	.0000	.0.0.	.0....	.000.	.000.	.000.	.000.	.000.	.000.	0....0	.000.
90H	..0.	..0.	..0.	..0.	..0.	..0.	.0.	.0.	.000.	.0.	.0.	.0.	.0.	.0.	.0.	.0.
	00000	00000	00000	.....	00000	.000.	.0.	.0.	.000.	.0.	.0.	.0.	.0.	.0.	.0.	.0.
	0....	0....	0....	.000.	0....	.0.	0....0	0....0	0....0	0....0	0....0	0....0	0000.	0....0	0....0	.000.
	0000.	0000.	0000.	0....0	0000.	..0.	0....0	0....0	0....0	0....0	0....0	0....0	.0.	0....0	0....0	.000.
	0....	0....	0....	0....0	0....0	0....0	0....0	0....0	0....0	0....0	0....0	0....0	.0000	0....0	0....0	0....0
	00000	00000	00000	.0000	00000	.000.	.00.0	00.0	.000.	.0.	.0000	.0000	.0000	.000.	.000.	.000.
A0H	..0.	..0.	..0.	..0.	..0.	.0.0.	.....	00000	.0.	.....	.....	0.0.	0.0.	00..	...0.	0....
	..0.	..0.	..0.	..0.	..0.	.....	.....	.0.0.	.....	.....	.....	0.0.	0.0.	.0.	.0.0	0.0.
	..0.	..0.	.....	.000.	.....	.....	0.00.	.....	.....	.....	.....	00..	00..	0.	0.0.	0.0.
	..0.	00.	.....	0....0	0....0	.000.	.....	.000.	00000	00000	0.00.	0.00.	0.00	0.0	0.0.	0....0
	..0.	..0.	.....	0....0	0....0	0....0	.....	.....	0....0	0....0	0....0	0....0	00.00	00.00	0.0.	0.0.
	..0.	..0.	.....	0....0	0....0	0....0	.....	.....	.0.	0....	0....	0....	00000	.0000	.0000	0....0
	..0.	.000.	.....	.000.	00.0	.....	.....	.....	0....	0....	0....	0....	0....	0....	0....	.0.
B0H	.0.0.	0.0.0	00000	..0.	..0.	..0.	.0.0.	.....	.....	.0.0.	.0.0.	.....	.0.0.	.0.0.	.0.	.....
	0.0.0	0.0.0	00000	..0.	..0.	..0.	.0.0.	.....	.....	.0.0.	.0.0.	.....	.0.0.	.0.0.	.0.	.....
	0.0.0	0.0.0	00000	..0.	..0.	.000.	.0.0.	.....	000.	00.0.	0.0.	0000.	00.0.	0.0.	000.	.....
	0.0.0	0.0.0	00000	..0.	.000.	..0.	00.0	0000.	..0.	.0.	0.0.	.....	.0.	0000.	0....	000.
	0.0.0	0.0.0	00000	..0.	.000.	..0.	.000.	.0.0.	000.	00.0.	00.0.	00.0.	0000.	.....	000.	.0.
	0.0.0	0.0.0	00000	..0.	..0.	..0.	.0.0.	.0.0.	.0.	.0.0.	.0.0.	.0.0.	.0.0.	.....	.....	.0.
	0.0.0	0.0.0	00000	..0.	..0.	..0.	.0.0.	.0.0.	.0.	.0.0.	.0.0.	.0.0.	.0.0.	.....	.....	.0.
C0H	..0.	..0.	.....	.0.	.....	..0.	.0.	.0.	.0.0.	.0.0.	.....	.0.0.	.....	.0.0.	.0.	.0.
	..0.	..0.	.....	.0.	.....	..0.	.0.	.0.	.0.0.	.0.0.	.....	.0.0.	.....	.0.0.	.0.	.0.
	..0.	..0.	.....	.0.	.....	..0.	.000	.0.0.	.0.00	00.00	00000	.0.00	00000	.0.00	00000	00.00
	.000	00000	00000	.000	00000	00000	.0.	0.00	0....	.....	.....	.0.00	00000	.0.00	00000	00.00
	.....	..0.	..0.	.....	..0.	.0000	.0.0.	.0000	.0.00	00000	00.00	.0.00	00000	.0.00	00000	00.00
	.....	..0.	..0.	.....	..0.	.0.	.0.	.0.	.0.	.0.	.....	.0.0.	.0.0.	.....	.0.	.....
	.....	..0.	..0.	.....	..0.	.0.	.0.	.0.	.0.	.0.	.....	.0.0.	.0.0.	.....	.0.	.....
D0H	.0.0.	.....	.....	.0.0.	..0.	.....	.....	.0.0.	.0.	..0.	.....	00000	.....	000.	..000	00000
	.0.0.	.....	.....	.0.0.	..0.	.....	.....	.0.0.	.0.	..0.	.....	00000	.....	000.	..000	00000
	.0.0.	00000	.....	.0.0.	.000	.0000	.0000	.0.0.	00000	.0.	.....	00000	.....	000.	..000	00000
	00000	.....	00000	.0000	..0.	.0.	.0.0.	00000	.0.	000.	..000	00000	00000	000.	..000	00000
	.....	00000	.0.0.	.....	.000	.000	.0.0.	.0.0.	00000	.....	.0.	00000	00000	000.	..000	.....
	.....	..0.	.0.0.	.....	..0.	.0.0.	.0.0.	.0.	.0.	.....	.0.	00000	00000	000.	..000	.....
	.....	.0.	.0.0.	.....	..0.	.0.0.	.0.0.	.0.	.....	.0.	00000	00000	000.	..000	.....	.....
E0H	...0	..00.	00000	00000	00000	..000	.....	.....	.000.	.000.	.000.	.0000	.....	..0	.000.	.000.
	...0	0.0.0	0.0.0	0.0.0	0.0.0	0.0.0	.....	.....	.000.	0.0.0	0.0.0	0....	.0.0.	.0.0.	0....	0.0.0
	.00.0	.000.	0....	.0.0.	.0.	0.0.	0.0.0	00000	0.0.0	0.0.0	0.0.0	0....	.0.0.0	.000.	0....	0.0.0
	0.0.	0.0.0	0....	.0.0.	..0.	0.0.	0.0.	0.00	0....	0.0.0	00000	0.0.	.000.	0.0.0	0000.	0....0
	0.0.	0.0.0	0....	.0.0.	.0.	0.0.0	000.0	0....	0.0.0	0.0.0	0.0.0	0....	0.0.0	0.0.	0....	0.0.0
	0.0.0	.000.	0....	.0.0.	0.0.0	0.0.0.	.....	.....	.000.	0.0.0	0.0.0	0....	.....	.000.	0....	0.0.0
	00..0	00..	0....	0.00	00000	.00.	0....	..00.	.000.	.000.	00.00	.000.	.....	0....	.000.	0....0
F0H	00000	.....	0....	..0	..0.	..0.	.....	.00.0	.000.	.....	.....	.0000	.0.0.	.00.	.....	.....
	.....	..0.	..0.	..0.	..0.	..0.	.....	.0.00.	.0.0.	.....	.....	.00.0	.0.	.0	.000.	.....
	00000	00000	..0.	..0.	..0.	..0.	00000	.00.0	.00.	..0.	..0.	.0.	.0.	.0	.000.	.....
	.....	..0.	00000	00000	..0.	..0.	.....	0.00.	.....	.....	.....	.0.	.....	.0000	000.	.....
	.....	.0.	.....	.....	.0.	0.0.	.....	.....	.....	.....	.....	.00.	.....	.....	000.	.....
	00000	00000	00000	00000	..0.	..0.	.....	.....	.....	.....	.....	.0.	.....	.....	.....	.....

Table 7-7

# WD-202P customer display

## 7.8 Page 5 (PC865: Nordic) (80H – FFH)

	00	01	02	03	04	05	06	07	08	09	0A	0B	0C	0D	0E	0F
80H	.0000	.0.0.	...0.	.0.	.0.0.	.0.	...0.	.....	.0.	.0.	.0.	.0.0.	.0.	.0.	.0.0.	.0.
	.0.	...	...0.	.0.0.	.....	.0.	.0.0.	.0000	.0.0.	.0.	.0.	.....	.0.0.	.0.	.....	.0.0.
	...0.	.0.0.	.000.	.000.	.000.	.000.	.0.	...0.	.000.	.0000	.000.	.....	.0.0.	.0.	.....	.0.0.
	.0.	...0.	.0.0.0.	.0.	.0.	.0.	.0000	.0.	.0.	.0.	.0.	.0.	.....	.0.0.	.0.	.....
	.0000	.0.0.	.00000	.0000	.0000	.0000	.0000	.0000	.0000	.0000	.0000	.0000	.0.	.0.	.00000	.0.0.
	.0.	.0.	.00.0.	.000.	.0.0.	.0.	.0.0.	.0.	.0.	.0.	.0.	.0.	.0.	.0.	.00000	.00000
	...0.	...0.0.	.0000	.0000	.0000	.0000	.0000	.0.	.000.	.0000	.000.	.000.	.000.	.000.	.000.	.0.0.0.
90H	...0.	.....	.0000	.0.	.0.0.	.0.	...0.	.0.	.0.0.	.0.0.	.0.0.	.....	.00.	.0.	.0000	.....
	.0000	.00.00	.0.	.0.0.	.....	.0.	.0.0.	.0.	.000.	.0.	.000.	.0.	.0.	.000.	.0.0.0.	.0000
	.0.	...0.	.0.000.	.000.	.000.	.000.	.0.	.0.	.0.	.0.	.0.	.0.0.	.0.0.	.0000	.0.0.	.000.
	.0000.	.00000	.000.	.0.0.	.0.	.0.0.	.0.0.	.0.	.0000	.0.	.0.0.	.0.0.	.0.0.	.0.	.0.0.	.0000
	.0.	.0.	.0.0.	.0.0.	.0.0.	.0.0.	.0.0.	.00.	.0.	.0.0.	.0.	.000.	.0.	.000.	.0.0.	.0.0.
	.00000	.00.00	.0.000.	.000.	.000.	.000.	.00.0.	.00.0.	.0000.	.000.	.000.	.0.	.00000	.0.	.0.00	.0.
A0H	...0.	...0.	...0.	...0.	.00.0.	.00.0.	.000.	.000.	.0.	.....	.....	.0.0.	.0.0.	.0.	.....	.0.0.0.
	.0.	...0.	...0.	...0.	.0.0.	.0.0.	.000.	.0.	.0.	.....	.....	.0.0.	.0.0.	.....	.0.0.	.000.
	.000.	.....	.....	.....	.....	.....	.0000	.0.	.0.	.00000	.00000	.00.	.0.	.0.	.0.	.0.0.0.
	.0.	.000.	.....	.000.	.0.0.	.0.0.	.00.0.	.0.	.0.	.....	.....	.0.00.	.0.00.	.0.	.0.0.	.0.0.
	.0000.	.0.0.	.0.0.	.0.0.	.0.0.	.0.0.	.0.0.	.0000	.000.	.0.	.....	.0.	.0.0.	.0.	.0.0.	.0.0.
	.0.	.0.	.0.0.	.0.0.	.0.00	.0.0.	.0.00	.0.	.0.	.....	.....	.0.	.0000	.0.	.0.0.	.000.
	.0000.	.000.	.000.	.00.0.	.0.0.	.0.	.00000	.00000	.000.	.....	.....	.0000	.....	.0.	.0.	.0.0.0.
B0H	.0.0.	.0.0.	.00000	.0.	.0.	.0.	.0.0.	.....	.....	.0.0.	.0.0.	.....	.0.0.	.0.0.	.0.	.....
	.0.0.	.0.0.	.00000	.0.	.0.	.0.	.0.	.....	.....	.0.0.	.0.0.	.....	.0.0.	.0.0.	.0.	.....
	.0.0.	.0.0.	.00000	.0.	.0.	.000.	.0.0.	.....	.000.	.00.0.	.0.0.	.0000.	.00.0.	.0.0.	.000.	.....
	.0.0.	.0.0.	.00000	.000.	.0.	.00.	.00.0.	.0000.	.0.	.0.	.0.0.	.0.	.0.	.0000.	.0.	.000.
	.0.0.	.0.0.	.00000	.0.	.0.	.000.	.0.0.	.0.0.	.000.	.00.0.	.0.0.	.00.0.	.0000.	.....	.000.	.0.
	.0.0.	.0.0.	.00000	.0.	.0.	.0.	.0.0.	.0.0.	.0.	.0.0.	.0.0.	.0.0.	.....	.....	.0.	.0.
C0H	...0.	.0.	.....	.0.	.....	.0.	.0.	.0.0.	.0.0.	.....	.0.0.	.....	.0.0.	.....	.0.0.	.0.
	.0.	...0.	.....	.0.	.....	.0.	.0.	.0.0.	.0.0.	.....	.0.0.	.....	.0.0.	.....	.0.0.	.0.
	...0.	.....	.....	.0.	.....	.0000	.0.	.000	.0.0.	.0.00	.0000	.00.00	.00000	.0.	.00000	.00000
	.000	.00000	.0000	.000	.00000	.00000	.0.	.00.0.	.0.	.000	.0.	.0.	.0.	.0.	.00000	.00000
	.....	.00000	.0000	.0.	.0.	.000	.0000	.0.	.0000	.0.00	.00000	.00000	.0.	.0.	.00000	.00000
	.....	.0.	.0.	.0.	.0.	.0.	.0.	.0.	.0.	.0.	.00000	.0.0.	.0.0.	.....	.0.0.	.0.
	.....	.0.	.0.	.....	.0.	.0.	.0.	.0.	.0.	.0.	.0.	.0.0.	.0.0.	.....	.0.0.	.0.
D0H	.0.0.	.....	.....	.0.0.	.0.	.....	.....	.0.0.	.0.	.0.	.....	.00000	.....	.000.	.000	.00000
	.0.0.	.00000	.....	.0.0.	.000	.000	.0000	.0.	.0.	.00000	.0.	.....	.00000	.....	.000.	.000
	.00000	.00000	.00000	.0000	.0.	.0.	.0.	.00000	.0.	.000.	.0.	.000	.00000	.0000	.000.	.000
	.....	.00000	.0.0.	.....	.000	.000	.0.0.	.0.	.00000	.0.	.0.	.00000	.00000	.0000	.000	.000
	.....	.0.	.0.0.	.....	.0.	.0.0.	.0.0.	.0.	.0.	.....	.0.	.00000	.00000	.0000	.000	.000
	.....	.0.	.0.0.	.....	.0.	.0.0.	.0.0.	.0.	.0.	.....	.0.	.00000	.00000	.0000	.000	.000
E0H	.....	.0.	.00.	.00000	.00000	.00000	.000	.....	.000.	.000.	.000.	.0000	.....	.....	.0.	.000.
	.000.	.0.0.	.0.0.	.0.	.0.0.	.0.0.	.0.	.0.	.000.	.0.0.	.0.0.	.0.0.	.0.	.0.0.	.000.	.0.0.
	.00.0.	.000.	.000.	.0.0.	.0.0.	.0.0.	.0.	.0.	.00000	.0.0.	.0.0.	.0.0.	.0.	.0.0.	.000.	.0.0.
	.0.0.	.0.	.0.0.	.0.0.	.0.0.	.0.0.	.0.	.00.	.0.0.	.00000	.0.0.	.0.	.000.	.0.0.	.0000.	.0.0.
	.0.0.	.0.	.0.0.	.0.0.	.0.0.	.0.	.00000	.0.	.0.0.	.0.0.	.0.0.	.0.0.	.0.	.0.0.	.0.0.	.0.0.
	.00.0.	.000.	.000.	.0.	.0.0.	.0.	.0.	.0.	.000.	.0.	.0.0.	.0.	.0.	.000.	.000.	.0.0.
	.00.0.	.0.0.	.0.	.00.	.00000	.00.	.....	.00.	.000.	.000.	.00.00	.000.	.....	.000.	.000.	.0.0.
F0H	.00000	.....	.0.	.....	.0.	.0.	.....	.00.0.	.000.	.....	.....	.0000	.0.0.	.00.	.....	.....
	.....	.0.	.0.	.....	.0.0.	.0.	.0.	.000.	.0.0.	.....	.....	.0.	.00.0.	.0.	.0.	.000.
	.00000	.00000	.0.	.0.	.0.	.0.	.00000	.00.0.	.000.	.00.	.0.	.0.	.0.	.0.	.000.	.....
	.....	.0.	.00000	.00000	.0.	.0.	.0.	.000.	.0.	.....	.....	.0.	.....	.0000	.000.	.....
	.00000	.00000	.00000	.00000	.0.	.0.	.....	.....	.....	.....	.....	.0.	.....	.....	.000.	.....
	.00000	.00000	.00000	.00000	.0.	.0.	.....	.....	.....	.....	.....	.0.	.....	.....	.000.	.....

Table 7-8

# WD-202P customer display

## 7.9 Page 6 (Slavonic) (80H – FFH)

	00	01	02	03	04	05	06	07	08	09	0A	0B	0C	0D	0E	0F
80H	.000.	.0.0.	...0.	..0.	.0.0.	..0.	...0.	.000.	.00.	..0.0.	..0.0	..0.0	..0.	...0.	.0.0.	...0.
	0....	.....	...0.	..0.	..0.0.	..0.0.	...0.	0....	0....	..0.0.	..0.0.	..0.0.	..0.	...0.	..0.	...0.
	0....	.....	.000.	.000.	.000.	..0.	.0000	0....	..00.	.000.	.000.	.000.	.0000	.000.	.0000	0....
	0...0	0...0	0...0	0...0	0...0	0...0	0...0	0...0	0...0	0...0	0...0	0...0	0...0	0...0	0...0	0...0
	.000.	0...0	00000	.0000	.0000	0...0	0....	.000.	.00.	00000	0...0	0...0	0...0	...0.	.0000	0....
	...0.	0...0	0...0	0...0	0...0	0...0	0....	..0.	0....	0....	0...0	0...0	0...0	0...0	0...0	0...0
	.0000	.000.	.0000	.0000	.0000	.000.	.0000	0....	.000.	.0000	.000.	.000.	.000.	.0000	.0000	.0000
90H	...0.	...0.	...0.	...0.	...0.	...0.	...0.	...0.	...0.	...0.	...0.	...0.	...0.	...0.	...0.	...0.
	.000.	0...0.	...0.	...0.	...0.	...0.	...0.	...0.	...0.	...0.	...0.	...0.	...0.	...0.	...0.	...0.
	0...0	0...0	.000.	0...0	0...0	0...0	0...0	0...0	0...0	0...0	0...0	0...0	0...0	0...0	0...0	0...0
	00000	0...0	0...0	0...0	0...0	0...0	0...0	0...0	0...0	0...0	0...0	0...0	0...0	0...0	0...0	0...0
	0...0	0...0	0...0	0...0	0...0	0...0	0...0	0...0	0...0	0...0	0...0	0...0	0...0	0...0	0...0	0...0
	.0000	.000.	.000.	.000.	.000.	.0000	.0000	.0000	.0000	.000.	.000.	...0.	...0.	.000.	0...0	.0000
A0H	...0.	...0.	...0.	...0.	.000.	.000.	.0.0.	.0.0.	.000.	.000.	.....	...0.	.0.0.	.0000	...0.	.0...
	...0.	...0.	...0.	...0.	...0	...0	...0.	...0.	0...0	0...0	.....	...0.	...0.	0...0	...0	0...0.
	.000.	.....	.000.	.....	.0000	.0000	.00000	.00000	.00000	.00000	.....	.00000	.0000.	.000.	.000.	0...0.
	...0	.00.	0...0	0...0	0...0	0...0	...0.	...0.	0...0	0...0	.....	...0.	0...0	0...0	0...0	0...0
	.0000	...0.	0...0	0...0	0...0	.0000	.0000	...0.	...0.	.0000	.0000	...0.	0...0	.0000.	0...0.	0...0.
	0...0	0...0	0...0	0...0	0...0.	0...0.	0...0.	0...0.	0...0.	0...0.	.....	0...0.	0...0.	0...0	0...0	0...0.
	.0000	.000.	.000.	.000.	.000.	.000	.0000	.0000	.0000	.0000	.....	.0000	.0000.	.000.	.000.	0...0.
B0H	0.0.0	0.0.0	00.00	..0.	..0.	...0.	..0.	.0.0.	.0000	.....	.....	.....	.....	..0.	.0.	.....
	.....	0.0.	.000.	0...0.	0...0.	0...0.	0...0.	0...0.	0...0.	.....	.....	.....	.....	.000.	.000.	.....
	0.0.0	0.0.0	00.00	0...0.	0...0.	0...0.	0...0.	0...0.	0...0.	.....	.....	.....	.....	...0.	...0.	.....
	0.0.0	0.0.0	00.00	0...0.	0...0.	0...0.	0...0.	0...0.	0...0.	.....	.....	.....	.....	.00000	.00000	.....
	0.0.0	0.0.0	00.00	0...0.	0...0.	0...0.	0...0.	0...0.	0...0.	.....	.....	.....	.....	...0.	...0.	.....
	0.0.0	0.0.0	00.00	0...0.	0...0.	0...0.	0...0.	0...0.	0...0.	.....	.....	.....	.....	...0.	...0.	.....
	0.0.0	0.0.0	00.00	0...0.	0...0.	0...0.	0...0.	0...0.	0...0.	.....	.....	.....	.....	.0000	.0000	.....
C0H	.....	.....	.....	.....	.....	..0.	.0.0.	.0.0.	.....	.....	.....	.....	.....	.....	.....	0...0
	.....	.....	.....	.....	.....	..0.	.0.	..0.	.....	.....	.....	.....	.....	.....	.....	.000.
	.....	.....	.....	.....	.....	0.	.000.	.000.	.....	.....	.....	.....	.....	.00000	.....	0...0
	.....	.....	.....	.....	.....	.00000	.00000	.....	0	.....	.....	.....	.....	.....	.....	0...0
	.....	.....	.....	.....	.....	..0.	.0000	.0000	.....	.....	.....	.....	.....	.00000	.....	0...0
	.....	.....	.....	.....	.....	..0.	0...0	0...0	.....	.....	.....	.....	.....	.....	.....	.000.
	.....	.....	.....	.....	.....	..0.	.0000	.0000	.....	.....	.....	.....	.....	.....	.....	0...0
D0H	...00.	...00.	.0.0.	.0.0.	.0.0.	.0.0.	...0.	...0.	.0.0.	.....	.....	.00000	.....	...0.	...0.	.00000
	...0.	...0.	...0.	...0.	...0.	...0.	...0.	...0.	...0.	.....	.....	.00000	.....	.000.	0.0.	.00000
	.0000	.0000	...0	.000.	...0	...0	.....	.....	.000.	.....	.....	.00000	.....	...0.	...0.	.00000
	.000.	.000.	.0000	0...0	.0000	0...0	.00.	...00.	0...0	.....	.....	.00000	.00000	...0.	0...0	.....
	0.0.	0.0.	0.0.	0...0	.00000	0...0	00.0	0...0.	0...0.	.....	.....	.00000	.00000	0...0	0...0	.....
	0.0.	0.0.	0.0.	0...0	0...0	0...0	0...0	0...0.	0...0.	.....	.....	.00000	.00000	0...0	0...0	.....
	.000.	.000.	.0000	.0000	.0000	0...0	.000.	.000.	.0000	.....	.....	.00000	.00000	...0.	.000.	.....
E0H	...0.	.00.	...0.	...0.	...0.	.0.0.	.0.0.	.0.0.	...0.	...0.	...0.	...0.0	...0.	...0.	...0.	...0.
	...0.	0...0.	0...0.	0...0.	0...0.	0...0.	0...0.	0...0.	...0.	...0.	...0.	0...0.	0...0.	0...0.	0...0.	0...0.
	.000.	.000.	.000.	.....	.....	.....	.0000	.0000	.....	.....	.....	.....	0...0	0...0	0...0.	.....
	0...0	0...0.	0...0.	0...0.	0...0.	0...0.	0...0.	0...0.	0...0.	0...0.	0...0.	0...0.	0...0.	0...0.	0...0.	0...0.
	0...0	0...0.	0...0.	0...0.	0...0.	0...0.	0...0.	0...0.	0...0.	0...0.	0...0.	0...0.	0...0.	0...0.	0...0.	0...0.
	0...0	0000.	0...0	0...0	0...0	0...0	0...0	0...0	0...0	0...0	0...0	0...0	0...0	0...0	0...0.	.....
	.000.	0...0.	.000.	0...0	0...0	0...0	0000.	.0000.	0...0.	.000.	0...0.	.000.	0...0.	0...0.	0...0.	.....
F0H	.....	0.0.	.....	0.0.	0...0	.000.	.....	.....	..0.	.0.0.	0...0.	...0.0	0...0.	0...0.	.....	.....
	.....	0.0.	.....	.....	.....	.....	.....	.....	0.0.	0...0.	.....	.....	.....	.....	.....	.....
	.000.	.....	.....	.....	.....	.000.	.....	.....	0.	.....	.....	.....	.....	.....	.000.	.....
	.....	.....	.....	.....	0...0	00000	.....	.....	.....	.....	.....	.....	0...0	00.0.	00.0.	.000.
	.....	.....	.....	.....	.000.	.....	.....	.....	.....	.....	.....	.....	0...0	00.0.	00.0.	.000.
	.....	.....	.....	.....	0...0	0...0	.....	.....	.....	.....	.....	.....	0...0	0...0.	0...0.	.....
	.....	.....	.....	.....	.000.	.0000.	.....	.....	.....	.....	.....	.....	.000.	0...0.	0...0.	.....

Table 7-9

## 7.10 Page 7 (Russia) (80H – FFH)

Table 7-10

### 7.11 Page 19 (PC858 Euro) (80H – FFH)

[illegible]

Table 7-11



**7.12 Page 16 (WPC1252) (80H – FFH)**

	00	01	02	03	04	05	06	07	08	09	0A	0B	0C	0D	0E	0F
80H	.00.	.0.0.	.....	..00	.....	.....	..0.	..0.	..0.	00..	.0.0.	.....	.0000	.....	.0.0.	.....
	.0..0	.....	.....	.....	.....	.....	..0.	..0.	..0.0	00..0	.0.	.....	0.0.	.....	.0.	.....
	000.	.....	00000	.....	.....	00000	00000	.....	.....	00..	.0000	..0.	0.0.	.....	00000	.....
	0..	.....	00..	.....	00.00	.....	0.	00000	.....	.....	00..	0..	.0.	0.000	.....	.0.
	000.	.....	00..	.....	00.00	.....	0.	00000	.....	.....	.....	000.	0.	0.0.	.....	0.
	.0..0	.....	..0.	.....	0.0	.....	..0.	..0.	.....	00.00	.0	0.	0.0.	.....	0.	0.
	..00.	.....	..00.	.....	0.0	0.0	0.	..0.	.....	00.00	0000.	.....	..0.	00000	.....	.....
90H	.....	.0.	..00.	.....	.0	00.00	.....	.....	.....	00.0	000.0	.0.0.	.....	.....	..0.0	.0.0.
	.....	..0.	..0.	0.0.	0.0	.....	.....	.....	0.0.	0.00	..0.	.....	.....	.....	..0.	.....
	.....	..00.	..0.	00.00	0.0.	.....	.....	.....	.....	..0.	0.000.	..0.	..0.00	.....	.....	0..0
	.....	.....	.....	.....	0000.	00000	00000	.....	.....	0..	..0.	0.0	0.	00000	0.0.	0.0.
	.....	.....	.....	.....	0000.	.....	.....	.....	.....	0000.	..0.	0.000	.....	.....	..0.	0.0.
	.....	.....	.....	.....	..0.	.....	.....	.....	.....	.....	0	0.0.	0.0.	.....	0.	0.
	.....	.....	.....	.....	.....	.....	.....	.....	.....	0000.	..0.	..0.00	.....	00000	.....	.....
A0H	.....	..0.	.....	..00.	.....	0..0	..0.	0000.	..0.0.	0000.	..00.	.....	.....	.....	0000.	0000.
	.....	..0.	0.0	0.0	0.0	0.0.	..0.	0..	.....	0..0	.....	0	.....	.....	0	.....
	.....	0000.	0..	0000.	00000	..0.	0000.	.....	.....	000.0	0000	0.0	.....	.....	000.0	.....
	.....	..0.	0.0.	00000	0.0	0.	0.	0..0	.....	..0.	0.	0.0	0.0.	00000	0000.	00.0
	.....	0.0.	0.	0.	0.	0.	0.	00000	..0.	0000.	0000	0.0.	0.	0.	0.0	0.
	.....	..0.	00000	0.	0000.	.....	0.	0.	0.	0.	0.	0.	0.	0.	0.	0.
	.....	0.	0.	0.0000	0.0	0.	0.	0000.	.....	0.0	.....	0.0	0.	0.	0.	0.
	.....	0.	0.	0.0000	0.0	0.	0.	0.	0.	0.	0.	0.	0.	0.	0.	0.
B0H	.00.	.0.	00.	00.	..0.	.....	0000	.....	.....	..0.	..00.	.....	0.0.	0.0.	00.0	.0.
	.0.0	.0.	0.0.	0.0.	0.0.	.....	000.0	.....	.....	00.	0.0	.....	0.0.	0.0.	.0.0.	.....
	.0.0	00000	..0.	.....	0.0.	000.0	.....	.....	.....	..0.	0.0	0.0.	0.0.	0.0.	0.0.	0.0.
	..00.	.0.	0.	0.0.	.....	0.0.	00.0	.....	.....	..0.	00.	.....	0.0.	0.00	0.000	0.00.
	.....	..0.	0000.	00.	.....	0.0.	00.0	.....	00.	.....	00.	.....	0.0	0.0	0.	0.
	.....	0.	0.	00000	0.0.	0.	0.	0.	0.	0.	0.	0.	0.	0.	0.	0.
	.....	00000	.....	.....	0000.0	0.0	0.	0.	0.	0.	0.	0.	0.	0.	0.	0.
	.....	00000	.....	.....	0.	0.0	.....	0000	.....	.....	0.0.	0.	0.	0.	0.	0.
C0H	.0..	..0.	0000.	00.0	0.0.	0.	0000.	0000.	0..	..0.	..0.	0.0.	0..	..0.	..0.	0.0.
	..0.	..0.	0.0	0.0	0.0.	.....	0.0.	0.0.	0.0	0.	0.0.	.....	0.0.	0.0.	0.0.	0.0.
	..0.	0.0.	0.	0.0.	0.0.	0.0.	0000.	0.0.	00000	00000	00000	00000	0000.	0000.	0000.	0000.
	0.0.	0.0.	0.0.	0.0.	0.0.	0.0.	0.0.	0.0000	0.0	0.	0.0.	0.0.	0.0.	0.0.	0.0.	0.0.
	0..0	0.0	0.0	0.0	0.0	0.0	0.0	0.00.	00000	00000	00000	00000	0000.	0.	0.	0.
	00000	00000	00000	00000	00000	00000	00000	0.0.	0.	0.	0.	0.	0.	0.	0.	0.
	0..0	0.0	0.0	0.0	0.0	0.0	0.0	0.000	00..	00000	00000	00000	00000	0000.	0000.	0000.
	0..0	0.0	0.0	0.0	0.0	0.0	0.0	0.000	00..	00000	00000	00000	00000	0000.	0000.	0000.
D0H	.000.	00.0	0..	..0.	0000.	00.0	0.0.	.....	00.0	0..	..0.	.....	0.0.	0.0.	..0.	00..
	0.0	0.0.	0.	0.	0.0.	0.0.	0.0.	.....	0.0	0.0.	0.0.	0.0.	.....	0.0.	0000.	0.0.
	0.0	.....	000.	0000.	0000.	0000.	0000.	0.0.	0.0	0.0	0.0	0.0.	.....	0.0	0.0.	0.0.
	000.0	00..0	0.0	0.0	0.0	0.0	0.0	0.0.	0.0.	0.0	0.0	0.0.	0.0.	0.0	0.0.	0.0.
	0.0	0.0	0.0	0.0	0.0	0.0	0.0	0.0.	0.0	0.0	0.0	0.0.	0.0.	0.0	0.0.	0.0.
	0.0	0.00	0.0	0.0	0.0	0.0	0.0	0.0	0.0	0.0	0.0	0.0.	0.0.	0.0	0.0.	0.0.
	000.	0.0	0.	0000.	0000.	0000.	0000.	.....	0.00.	0000.	0000.	0000.	0000.	0000.	..0.	0.0.
E0H	..0.	..0.	000.	00.0	0.0.	..00.	.....	.....	0..	..0.	000.	0.0.	0..	..0.	0000.	0.0.
	..0.	0..0	0.0	0.0.	0.0.	0.0	.....	0000	..0.	0.	0.0	0.	0.	0.	0.	0.
	000.	000.	..00.	00.	0000.	0000.	00.0.	0.....	000.	000.	000.	000.	.....	.....	00..	.....
	.....	0.....	0.....	0.....	0.....	0.....	0.0	0.0	0.0	0.0	0.0	0.0.	0.0.	00..	00..	.....
	0000	0000	0000	0000	0000	0000	0000	00000	00000	00000	00000	00000	0.	0.	0.	0.
	0..0	0.0	0.0	0.0	0.0	0.0	0.0.	0.0.	0.0	0.0	0.0	0.0.	0.0.	0.0.	0.0.	0.0.
	0000	0000	0000.	0000	0000	0000	00.00	0000.	00000	00000	00000	00000	0000.	0000.	0000.	0000.
F0H	0.0.	00.0	0..	..0.	..0.	00.0	0.0.	.....	.....	0.	..0.	0.0.	0.0.	..0.	0.0.	0.0.
	..00.	0.0.	..0.	0.0.	0.0.	0.0.	0.0.	.....	.....	0.0.	0.	0.0.	.....	0.	0.	0.
	0.0.	.....	0.00.	0000.	0000.	0000.	0000.	00000	0.	0.	0.0	0.0.	0.0.	0.0.	0.0.	0.0.
	0000	00.0	0.0	0.0	0.0	0.0	0.0	0.0.	0.0	0.0	0.0	0.0.	0.0.	0.0	0.0.	0.0.
	0..0	0.0	0.0	0.0	0.0	0.0	0.0	0.0.	0.0.	0.0	0.0	0.0.	0.0.	0.0	0.0.	0.0.
	000.	0.0	0.	0000.	0000.	0000.	0000.	0000.	0000	00.0	00.0	00.0	00.0	00.0	0000	0000
	000.	0.0	0.	0000.	0000.	0000.	0000.	0000.	0000	00.0	00.0	00.0	00.0	00.0	0000	0000

Table 7-12

Table 7-13

**APPENDIX A: Customer Display Dimension**

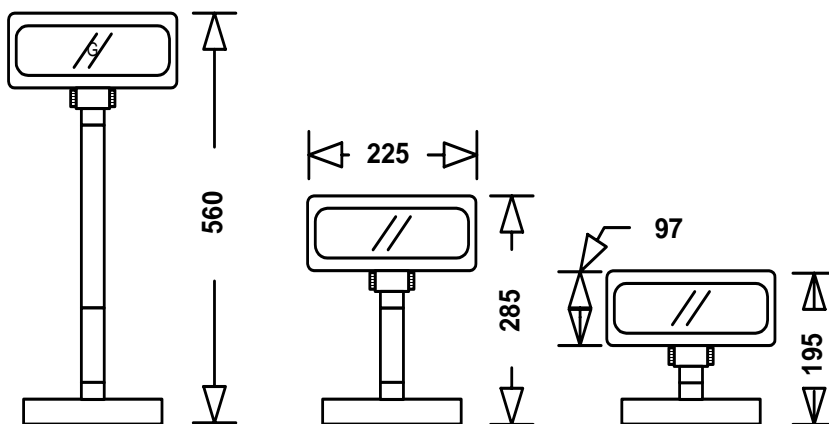

Unit : mm

**APPENDIX B: Display Base Dimension**

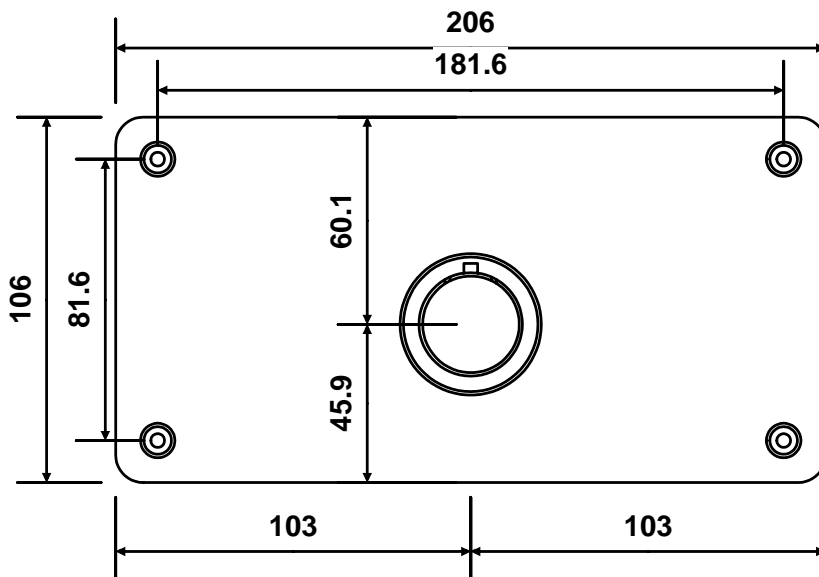

Unit : mm

## APPENDIX C: Display Module Dimension

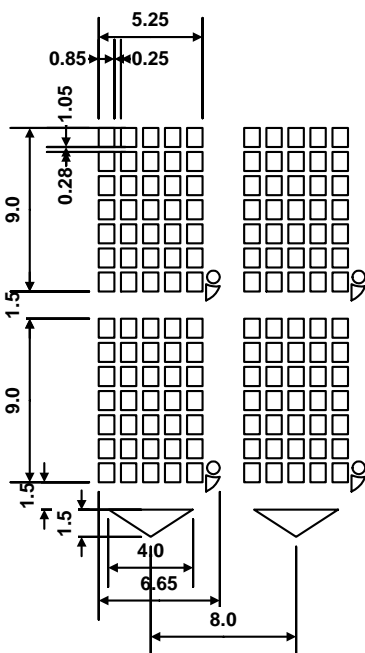
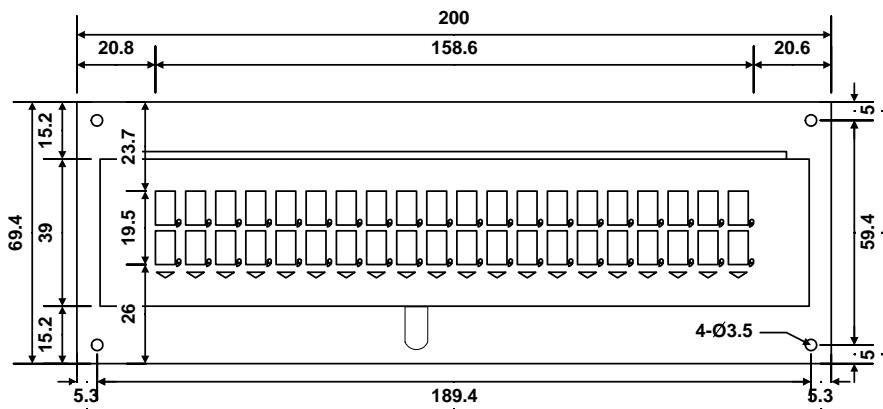

Unit : mm

## **APPENDIX D: Pass Through installation Guide**

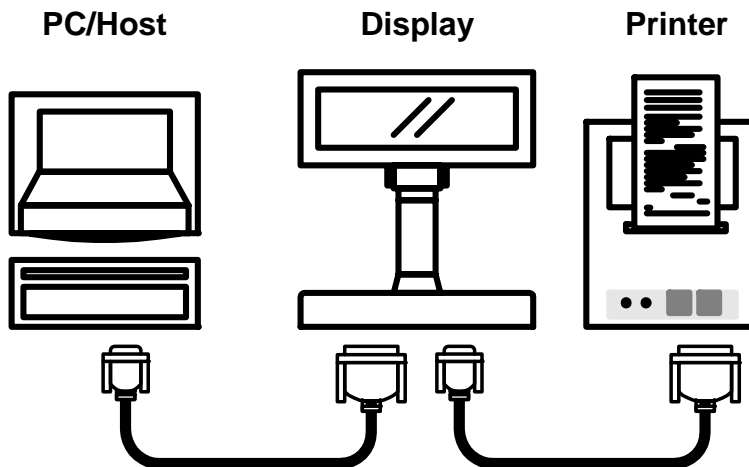

\*Only for CD5220/UTC/EMAX/EscPOS/DSP-800 emulation command sets.

\*If printer is EPSON TM serial printer then the pass through cable and display cable are same.